

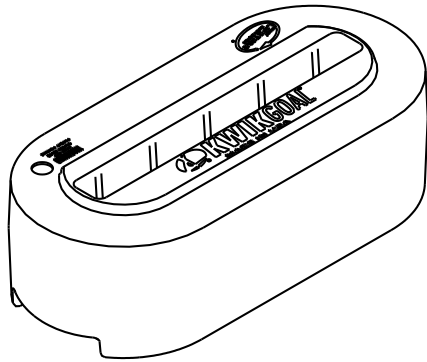

ASSEMBLY INSTRUCTIONS FOR 16B2308 TOM[®] BASE

Parts

Base
With Wheels (1)



O-Ring (1)

Fill Cap (1)



1. Fill TOM[®] base with sand.

WARNING
FILLED WEIGHT MUST
NOT EXCEED 50 LBS.

50 lbs.
bag of sand

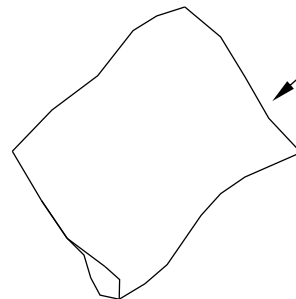

Large spout funnel
Maximum 1" dia. spout

Tilt & shake while filling
to allow more sand to be added

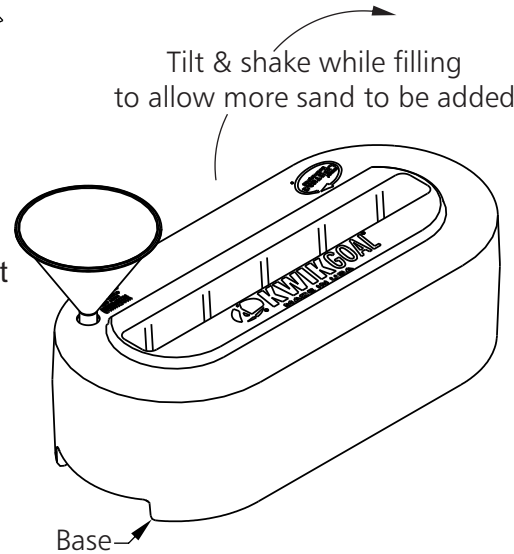

2. Put O-ring on fill cap, then center fill cap in hole and push the center of fill cap until it snaps into place.

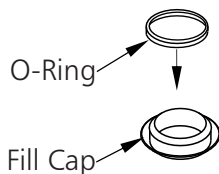

Fill Cap
w/ O-Ring

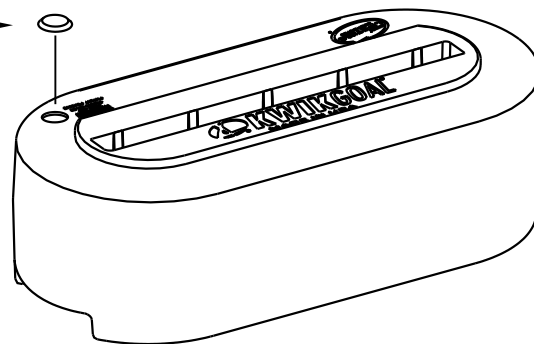

USE WITH TOM[®] (SOLD SEPARATELY)

3. Slide TOM[®] (SOLD SEPARATELY) into slot on filled base until it snaps into place.

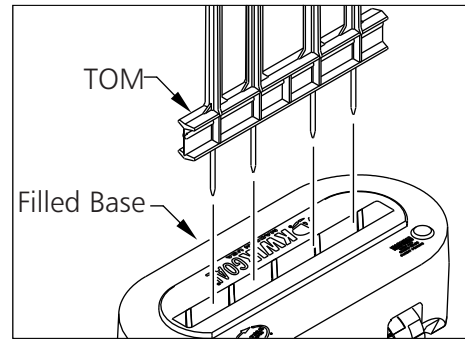
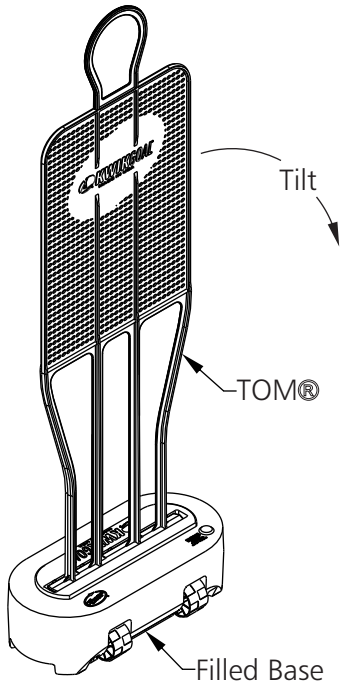

Move TOM[®] (SOLD SEPARATELY) to desired location by tilting on wheels and pulling.

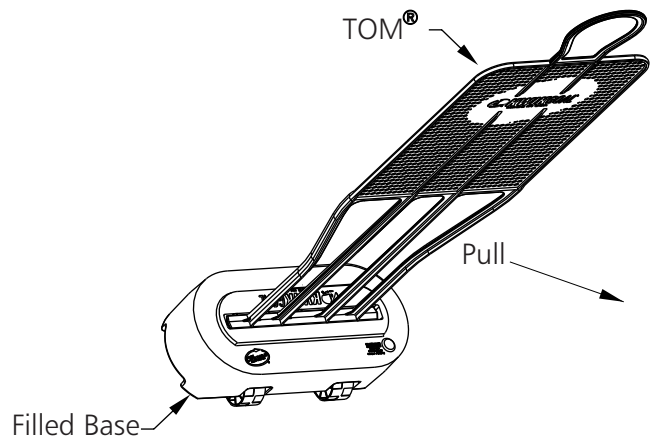

Stack Option

Bases can be stacked for storage or training purposes.

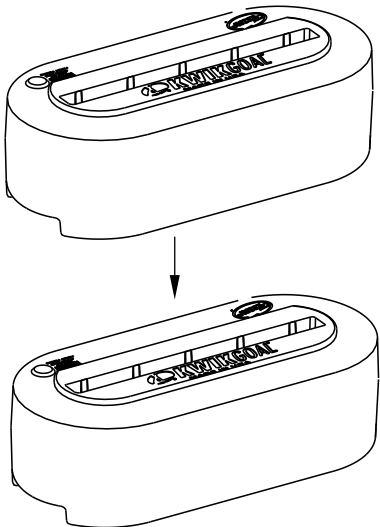

Hand Grip
(same on opposite side)

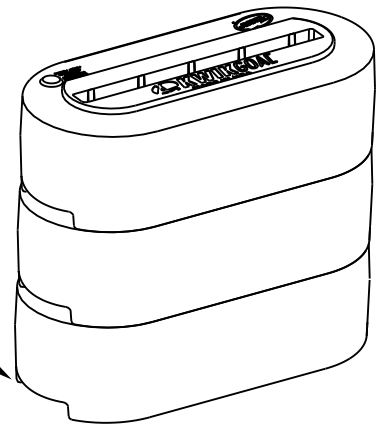

NOTE: It is not recommended to stack more than 4 filled bases.

Go to kwikgoal.com for additional product information.