



ASSEMBLY INSTRUCTIONS FOR 9B3208 LUXURY SEATS

1. Unpack all parts and check for damage that may have occurred during shipping. If damage has occurred, notify Kwik Goal immediately. Lay out all parts. Remove all cardboard and packaging immediately. Wet or damp packaging may damage contents.
2. Read through entire instruction before beginning assembly and installation.

NOTE: Components may be packaged in one or more additional boxes.

Parts

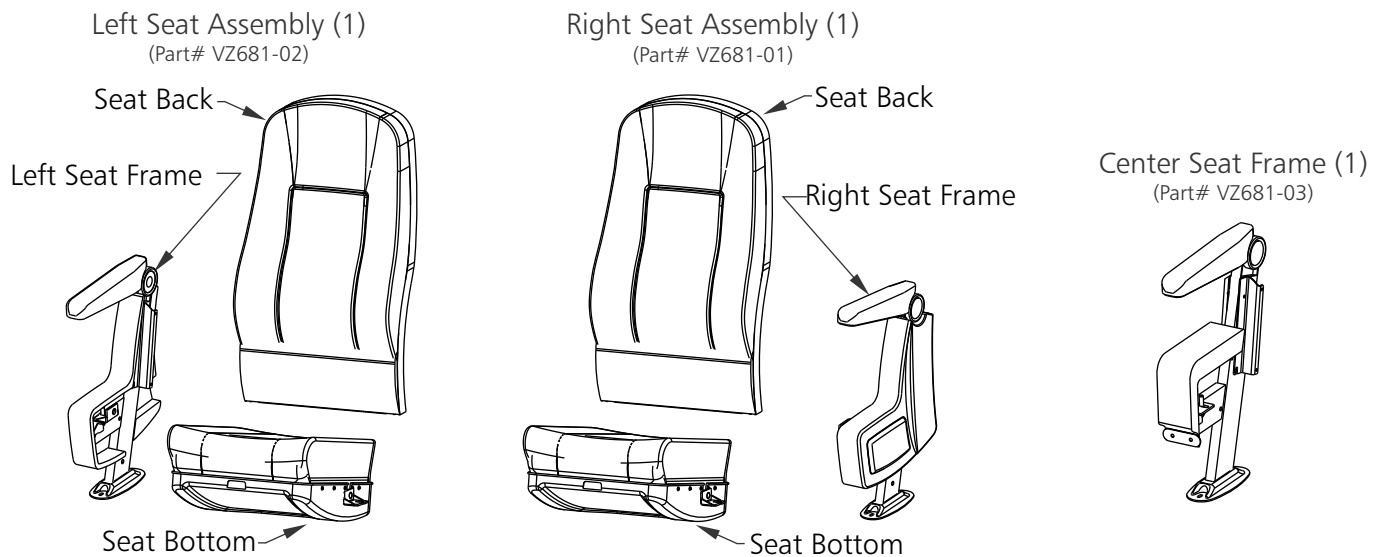

Assembly Tools

3/8, 7/16" & 1/2"
Wrenches

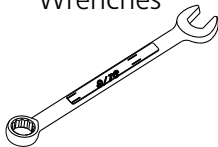

Ratchet with
3/8, 7/16" & 1/2"
Sockets

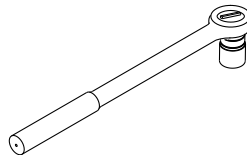

Phillips Screwdriver
P3

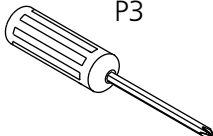

Standard Screwdriver

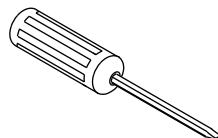

Hardware

1/4" x 1-3/4" Flange Bolt	(2)
1/4" x 1/2" Pan Head Screw	(1)
1/4" x 1" Flange Bolt	(4)
1/4" x 1" Flat Head	(4)
1/4" Tooth Lock Washer	(6)
1/4" Acorn Nut	(6)
5/16" Hex Nut	(4)
5/16" Lock Washer	(4)
5/16" Flat Washer	(4)

140 Pacific Drive Quakertown, PA 18951
800-531-4252 Kwikgoal.com
© 2020 Kwik Goal Ltd.

3. Disassemble left, right and center seat frames as shown.

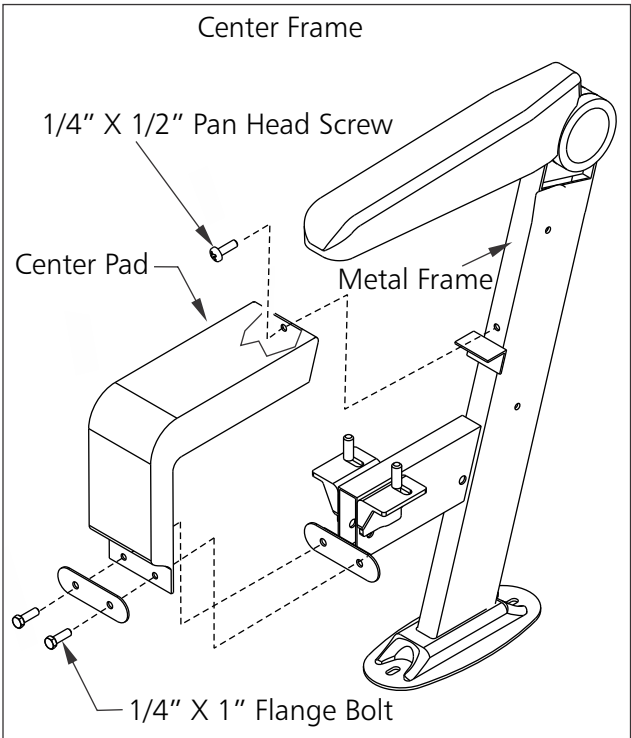
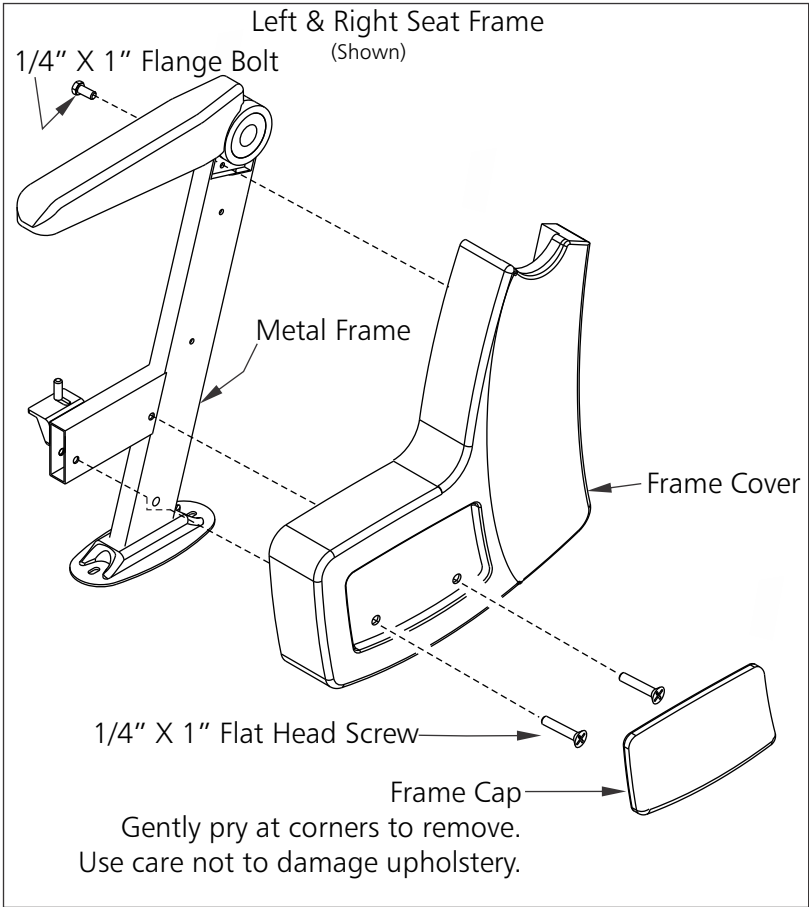

4. Seat backs can be attached at 2 angles. At the top of seat back bracket, use one of the holes to get the desired back angle and attach seat backs to metal frames as shown.
Note: Make sure all seat backs are at the same angle.

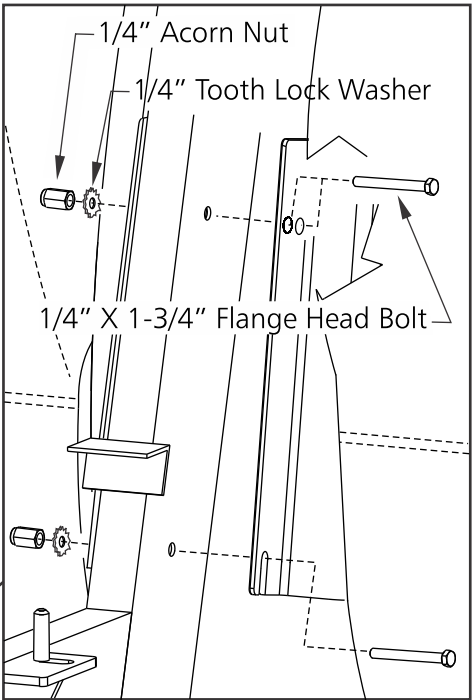
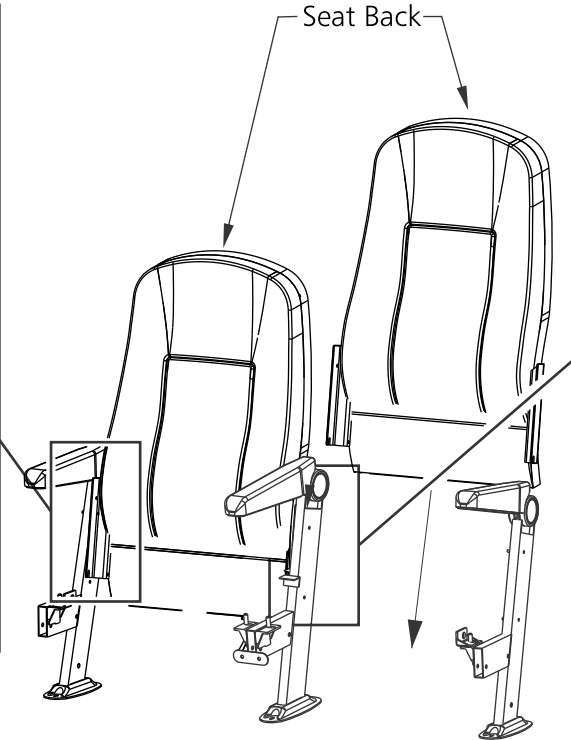
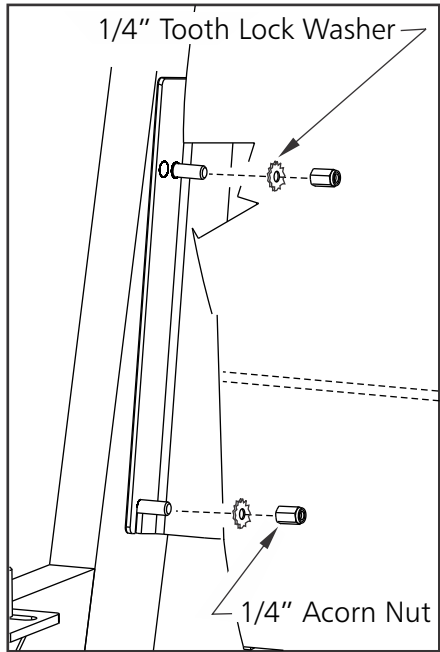

5. Attach seat bottoms to metal frames as shown. Tighten metal frames to base seat frame bolts.

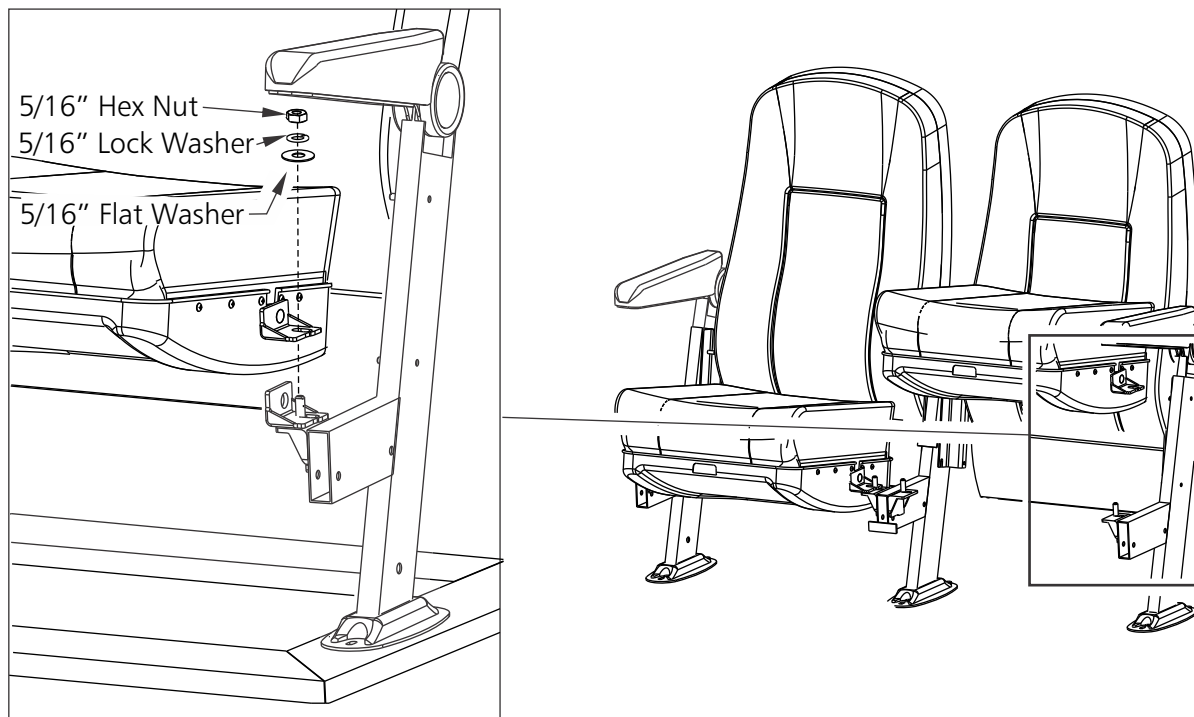

6. Attach center pad to seat frames as shown.

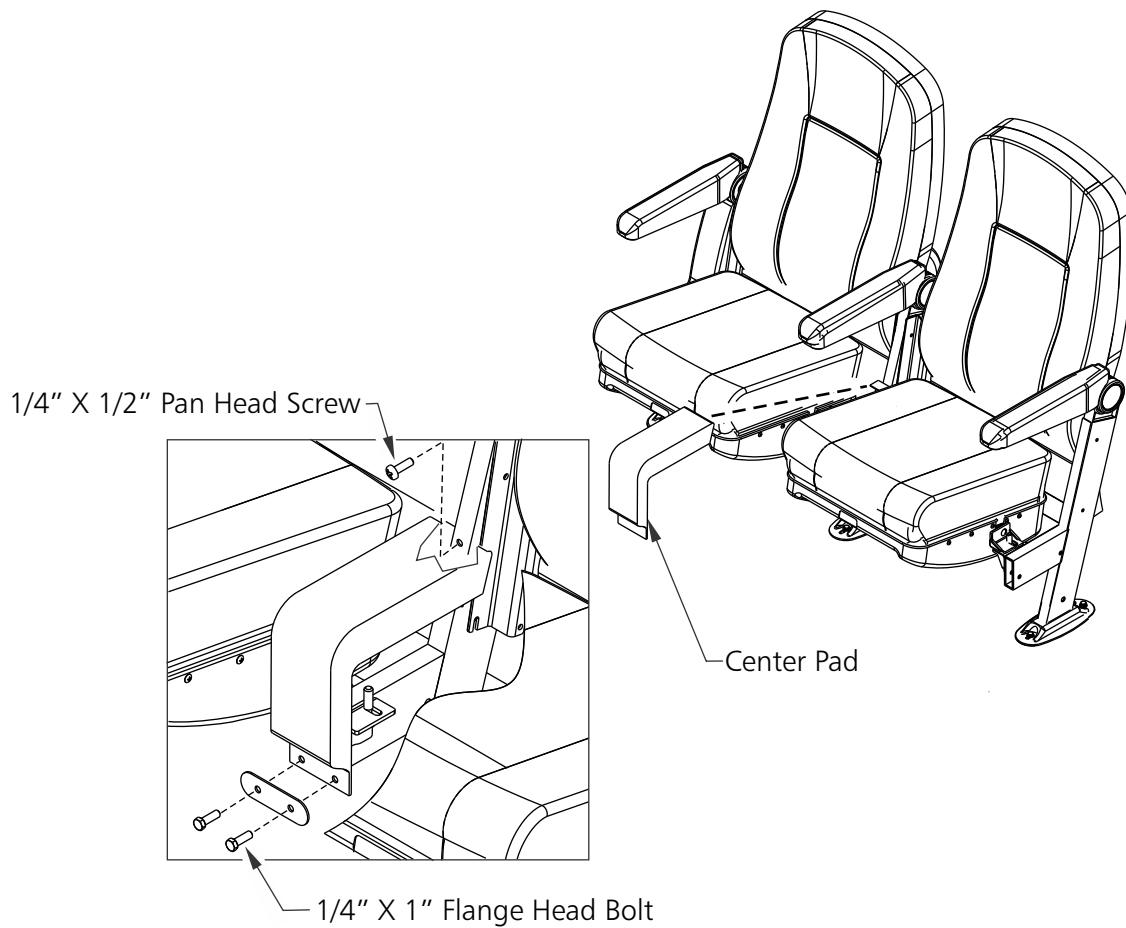

7. Attach frame covers and caps to seat frames as shown.

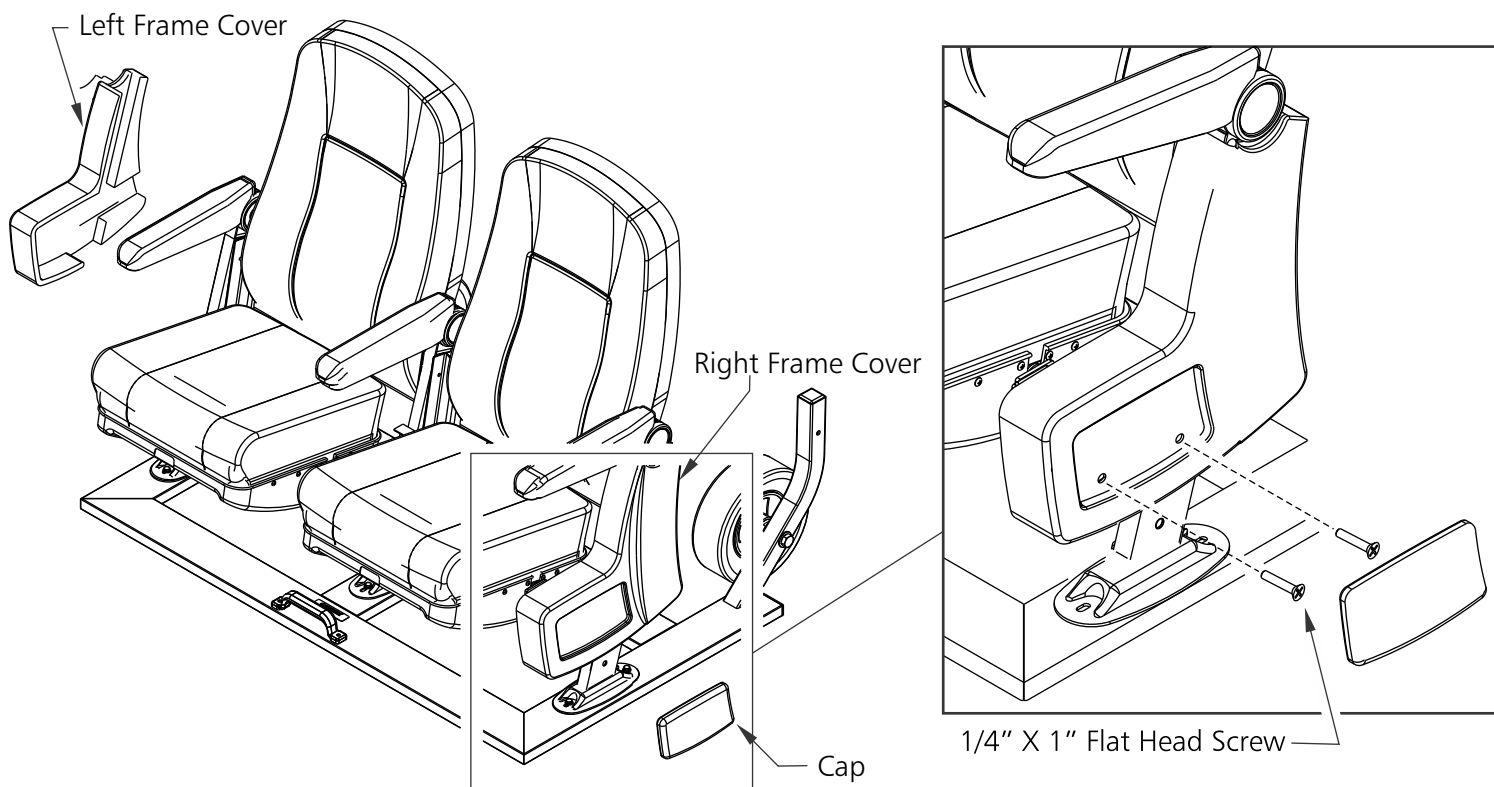

8. Anchor hole locations for seat frame shown below. Use anchor hardware appropriate for floor materials. Anchor at 6 locations per pair of seats.

OVERHEAD VIEW

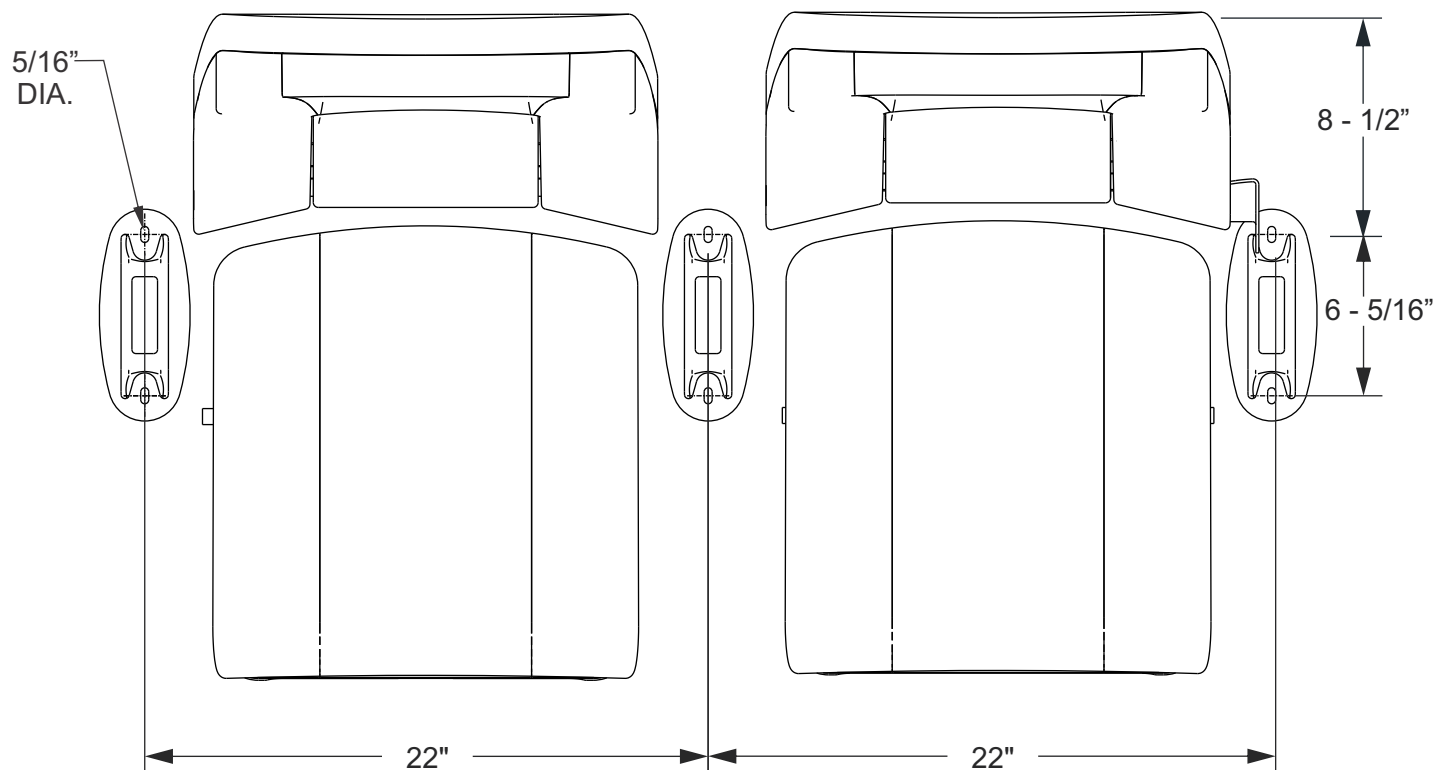

Go to Kwikgoal.com for additional product information.