



ASSEMBLY INSTRUCTIONS FOR 9B6501 SCORERS TOWER

***THIS UNIT MUST BE ASSEMBLED ON A FLAT AND LEVEL SURFACE
BY A MINIMUM OF FOUR QUALIFIED PERSONS***

1. Unpack all parts and check for damage that may have occurred during shipping. If damage has occurred, notify Kwik Goal immediately. Lay out all parts. Remove all cardboard and packaging immediately. Wet or damp packaging may damage contents.
2. Read through entire instruction before beginning assembly and installation.

NOTE: Components may be packaged in one or more additional boxes.

Parts for Chassis Assembly

Ladder Assembly (1)
(Part# UZ1635)

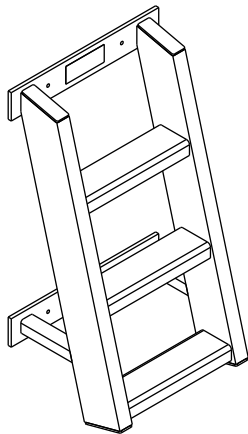

Stabilizer (4)
(Part# VZ843)

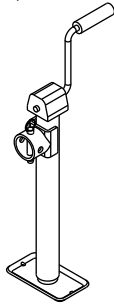

Stabilizer Connector (4)
(Part# UZ1638)

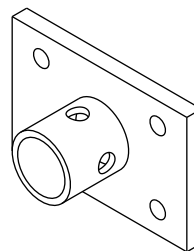

Hitch Coupler (1)
(Part# VZ847)

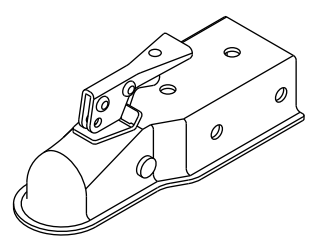

Hitch Holder (2)
(Part# UZ1646)

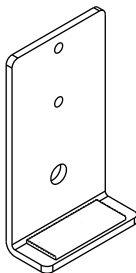

Fixed Wheel w/Brake (2)
(Part# VZ846)

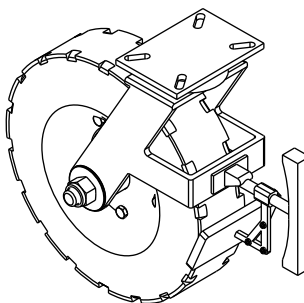

Swivel Wheel w/Brake (2)
(Part# VZ845)

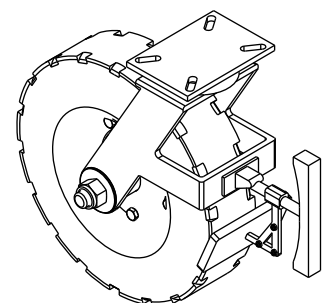

⚠ WARNING

THIS EQUIPMENT MUST BE STORED IN A SECURED, SHELTERED AREA WHEN NOT IN USE OR IN THE THREAT OF HIGH WINDS. ANY WEATHER DAMAGE TO THIS EQUIPMENT WILL NOT BE COVERED UNDER KWIK GOAL'S PRODUCT GUARANTEE. DO NOT LEAVE THIS EQUIPMENT UNATTENDED.

Parts for Chassis Assembly (continued)

Hitch Plate (1)
(Part# UZ1640)

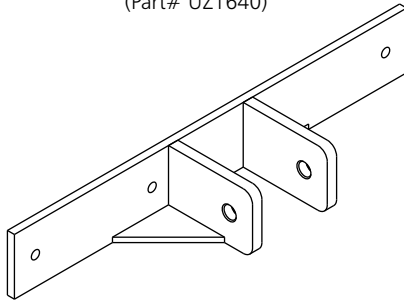

Tow Bar (1)
(Part# UZ1639)

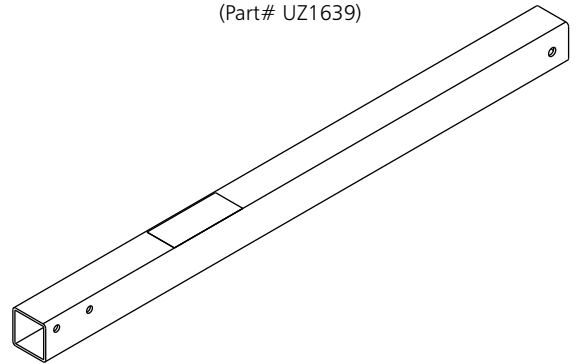

Hitch Pin (1)
(Part# VZ848)

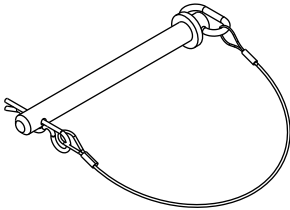

Top Plate (1)
(Part# UZ1645)

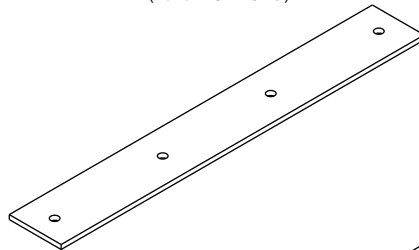

Floor (1)
(Part# UZ1642)

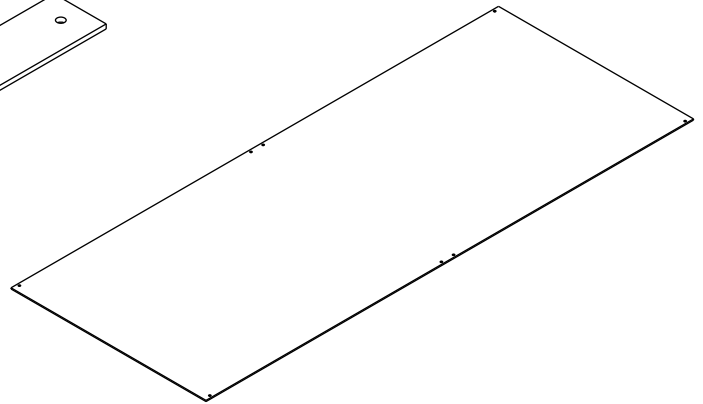

Chassis (1)
(Part# UZ1637)

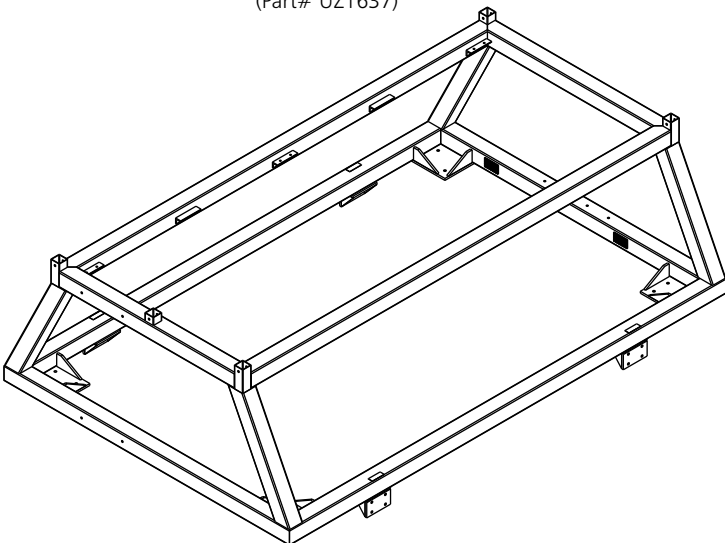

Floor Frame (1)
(Part# UZ1641)

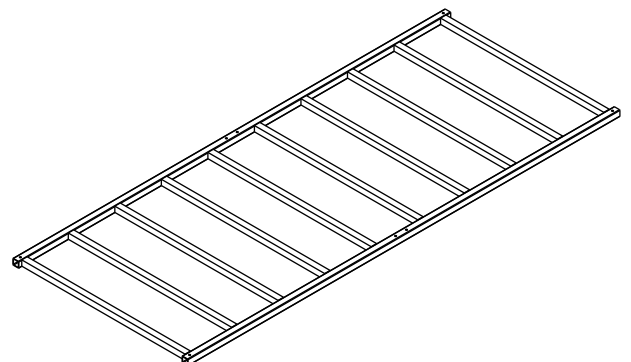

▲WARNING

THIS EQUIPMENT MUST BE STORED IN A SECURED, SHELTERED AREA WHEN NOT IN USE OR IN THE THREAT OF HIGH WINDS. ANY WEATHER DAMAGE TO THIS EQUIPMENT WILL NOT BE COVERED UNDER KWIK GOAL'S PRODUCT GUARANTEE. DO NOT LEAVE THIS EQUIPMENT UNATTENDED.

**⚠ WARNING****IMPORTANT SAFETY INSTRUCTIONS READ CAREFULLY**

1. This equipment is intended for use by persons of the age of 18 and older.
2. Perform routine inspections on all fasteners and components to ensure that they are secure and in good condition. Kwik Goal recommends routine inspections on a monthly basis, as well as before and after each use.
3. All stabilizer jacks must be in firm contact with solid ground whenever equipment is stationary.
4. Maintain at least one wheel in contact with the ground at all times. Stabilizer jacks are to be used for stabilization and leveling. DO NOT use stabilizer jacks to achieve additional height.
5. Tower may be wider than tow vehicle. When moving tower, pass people and objects carefully.
6. Disconnect and store tow hitch when tower is not being moved.
7. Moving heavy field equipment can be dangerous if not done properly. All Kwik Goal towers must be moved by qualified personnel who are experienced in moving large, heavy field equipment.
8. Never allow any person to ride on any part of the tower when moving.
9. A minimum of four qualified, experienced people are required to move the tower across short distances. Use extreme caution when pushing the tower. Avoid excessive force, as it can overturn the tower. Always push at lowest point on tower frame.
10. The tower can be moved with tow hitch using towing vehicle with a minimum towing capacity of 2000 lbs. Make sure adequate towing hardware is properly used, attached and secured.
11. Secure stabilizer jacks in horizontal position or remove completely before towing unit.
12. Maximum recommended safe towing speed:
6 MPH on field or uneven surfaces
10 MPH on hard, smooth surfaces
13. Never tow or push across an incline of greater than 10 degree slope.
Never tow or push up or down an incline of greater than 15 degree slope.
Never tow on public roadways.
14. Failure to properly follow all of safety instruction above can result in damage or injury.

NOTE: Hardware is packed separately in one or more boxes. Open all boxes and layout all sealed hardware packs before beginning assembly.

Ladder Hdw (Part#JZ247)

3/8" Flat Washer (Part# TZ189)	(8)
3/8" Lock Nut (Part# TZ197)	(4)
3/8" X 5-1/2" Hex Bolt (Part# TZ409)	(4)

Floor Hdw (Part#JZ249)

1/4" Flat Washer (Part# TZ361)	(8)
1/4" Lock Nut Thin (Part# TZ389)	(8)
1/4" X 2-1/2" Sidewalk Bolt (Part# TZ412)	(8)

Wheel Hdw (Part#JZ251) (2 pks)

1/2" Lock Nut (Part# TZ28)	(8)
1/2" Flat Washer (Part# TZ297)	(16)
1/2" X 1-3/4" Hex Bolt (Part# TZ411)	(8)

Stabilizer Hdw (Part#JZ254)

1/2" Lock Nut (Part# TZ28)	(16)
1/2" Flat Washer (Part# TZ297)	(32)
1/2" X 2" Hex Bolt (Part# TZ407)	(16)

NOTE: Remove chassis from skid and place on flat, level surface. Place on wood blocks or heavy cardboard to prevent damage to finish of chassis.

Tow Hitch Hdw (Part#JZ255)

5/16" X 1-1/4" Hex Bolt (Part# TZ311)	(4)
5/16" Lock Washer (Part#TZ174)	(4)
5/16" Flat Washer (Part# TZ4)	(4)
3/8" X 5-1/2" Hex Bolt (Part# TZ409)	(4)
3/8" Lock Nut (Part# TZ197)	(4)
3/8" Flat Washer (Part# TZ189)	(8)
1/2" X 4" Hex Bolt (Part# TZ20)	(2)
1/2" Flat Washer (Part# TZ297)	(4)
1/2" Lock Nut Thin (Part# TZ349)	(2)

Assembly Tools

7/16, 9/16/ 1/2
& 3/4" Wrench

Ratchet with
7/16, 9/16, 1/2
& 3/4" Socket

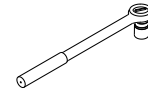
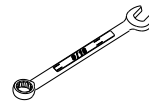

Phillips Screwdriver or Standard Screwdriver
P3

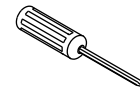
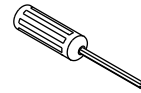

- If floor is already attached to chassis skip to step 5.
- Hardware for this step is in the **Floor Hdw** pack.
Place the floor frame and the floor on chassis as shown.
Tighten bolts after all eight bolts are properly seated.

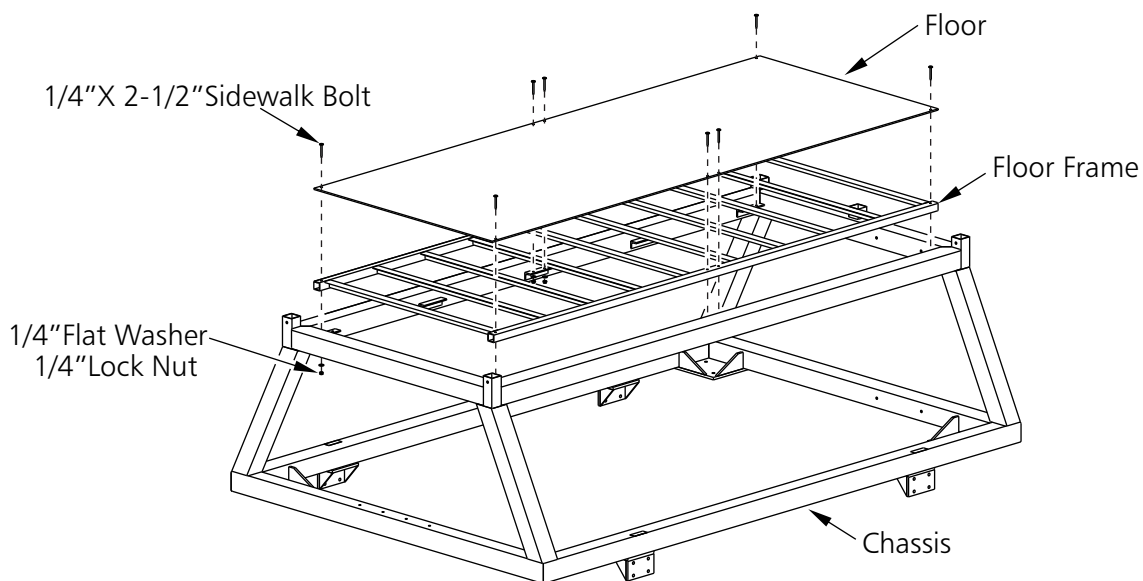

⚠WARNING

THIS EQUIPMENT MUST BE STORED IN A SECURED, SHELTERED AREA WHEN NOT IN USE OR IN THE THREAT OF HIGH WINDS. ANY WEATHER DAMAGE TO THIS EQUIPMENT WILL NOT BE COVERED UNDER KWIK GOAL'S PRODUCT GUARANTEE. DO NOT LEAVE THIS EQUIPMENT UNATTENDED.

5. Hardware for steps 5 and 6 are in the **Stabilizer Hdw** pack.
Attach stabilizer connector to chassis as shown.

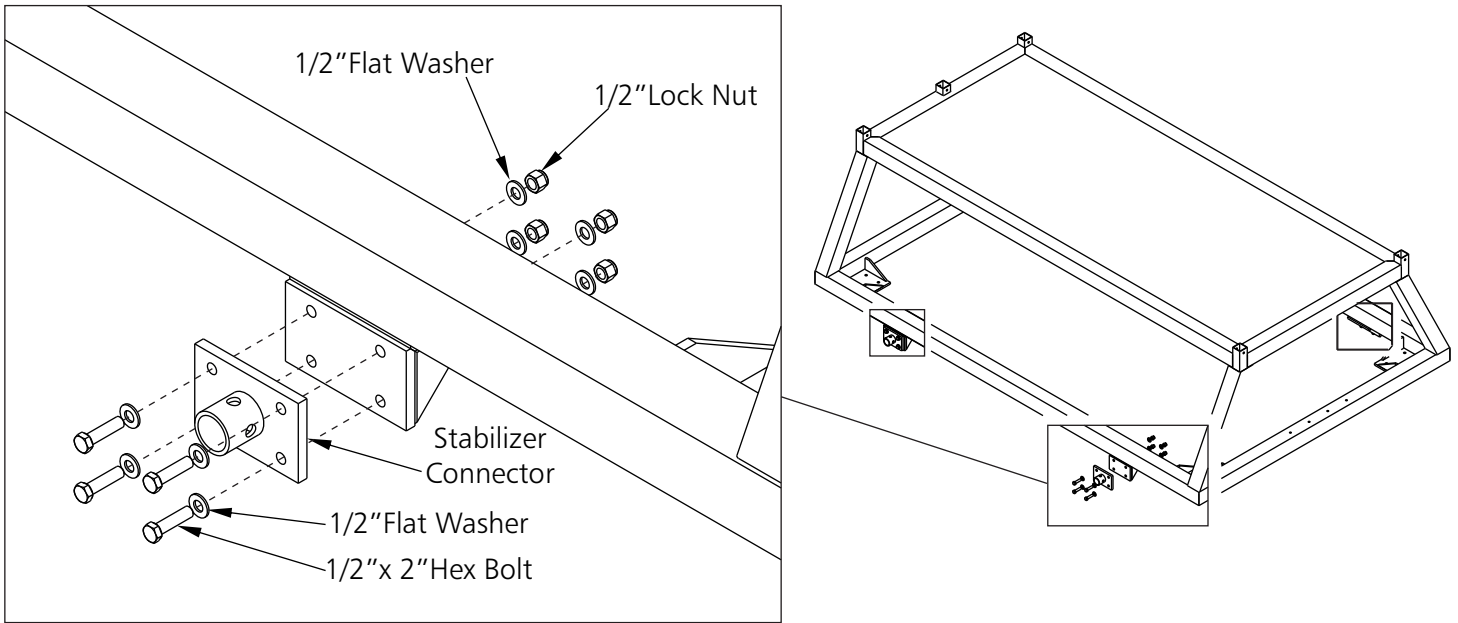

6. Using qualified persons, lift one side of the chassis and attach stabilizer to both elevated stabilizer connectors. Make sure locking pins are properly seated. Repeat this step for opposite side of chassis. All four stabilizers should be locked in place with pins.

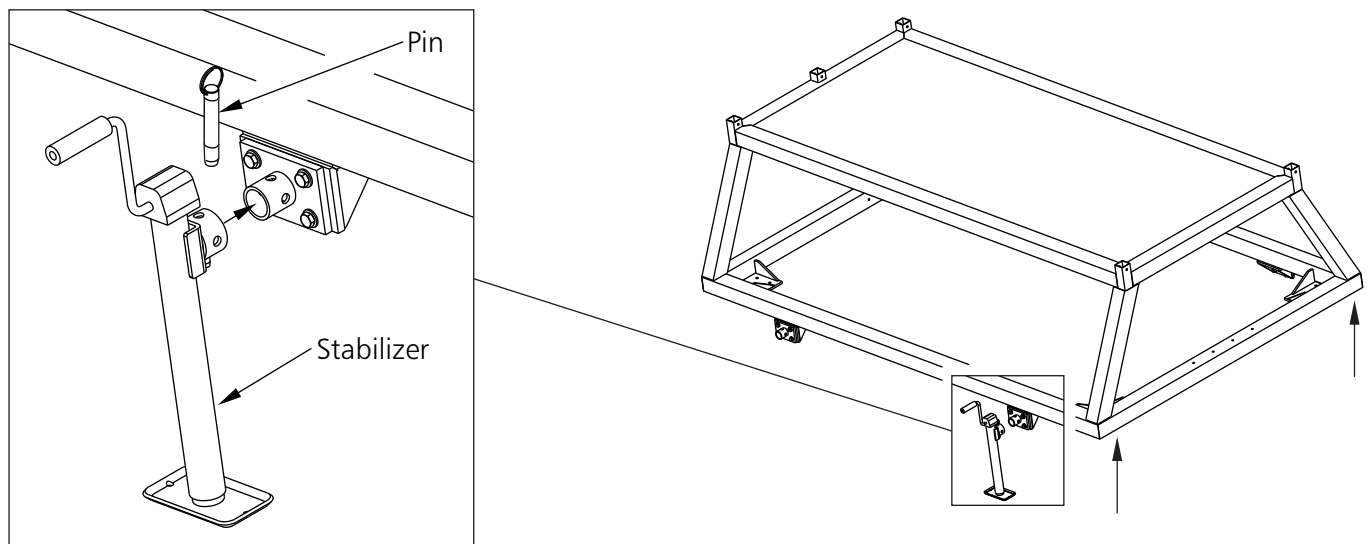

⚠ WARNING

THIS EQUIPMENT MUST BE STORED IN A SECURED, SHELTERED AREA WHEN NOT IN USE OR IN THE THREAT OF HIGH WINDS. ANY WEATHER DAMAGE TO THIS EQUIPMENT WILL NOT BE COVERED UNDER KWIK GOAL'S PRODUCT GUARANTEE. DO NOT LEAVE THIS EQUIPMENT UNATTENDED.

7. Hardware for this step is in the **Wheel Hdw** pack.

Use the stabilizers to elevate the chassis to allow proper clearance to mount each wheel assembly . Fixed wheels go on ladder side; swivel wheels go on hitch side. Reference illustration below.

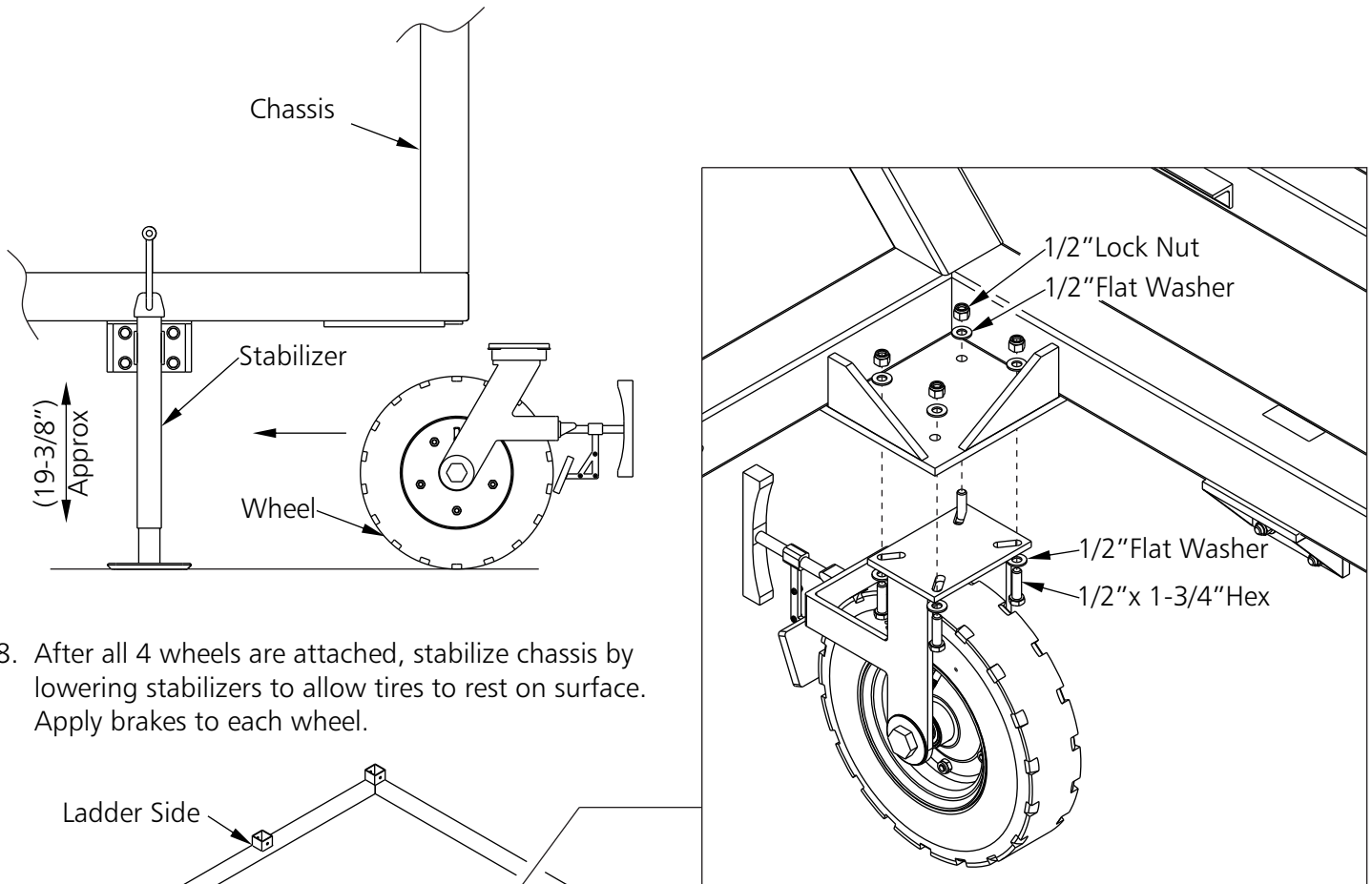

8. After all 4 wheels are attached, stabilize chassis by lowering stabilizers to allow tires to rest on surface. Apply brakes to each wheel.

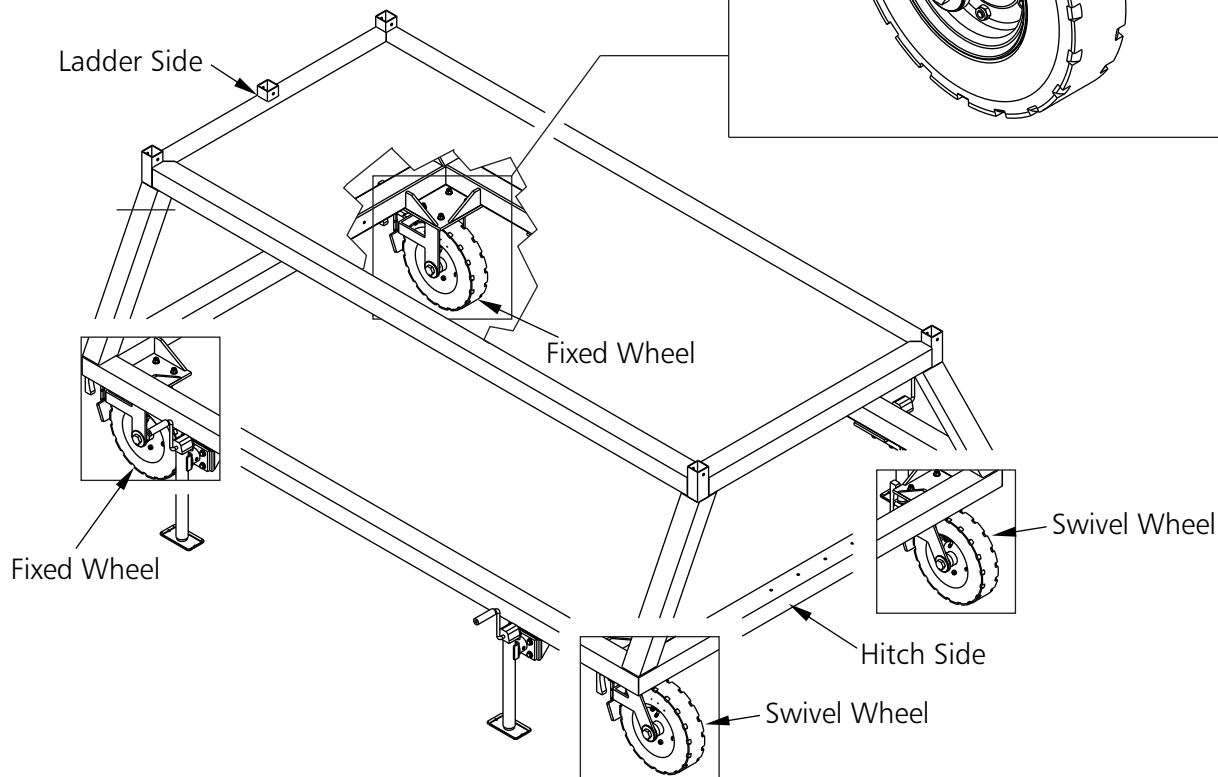

WARNING

THIS EQUIPMENT MUST BE STORED IN A SECURED, SHELTERED AREA WHEN NOT IN USE OR IN THE THREAT OF HIGH WINDS. ANY WEATHER DAMAGE TO THIS EQUIPMENT WILL NOT BE COVERED UNDER KWIK GOAL'S PRODUCT GUARANTEE. DO NOT LEAVE THIS EQUIPMENT UNATTENDED.

9. Hardware for steps 9, 10, and 11 is in the **Tow Hitch Hdw** pack.
Attach both hitch holders to the chassis threaded inserts as shown.
Do Not overtighten bolts.

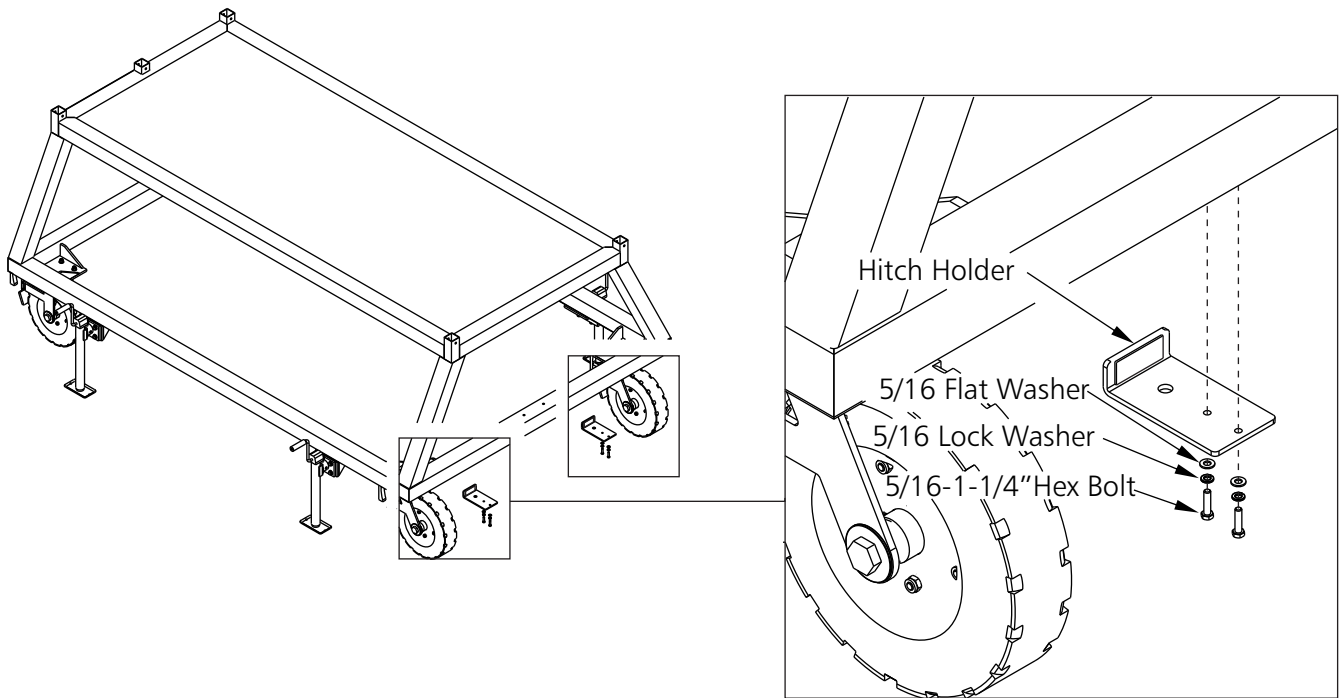

10. Attach both the hitch plate and the top plate to the chassis as shown. **Note: Keep gusset on hitch plate to the inside of chassis frame. Do not overtighten bolts. Chassis damage could result.**

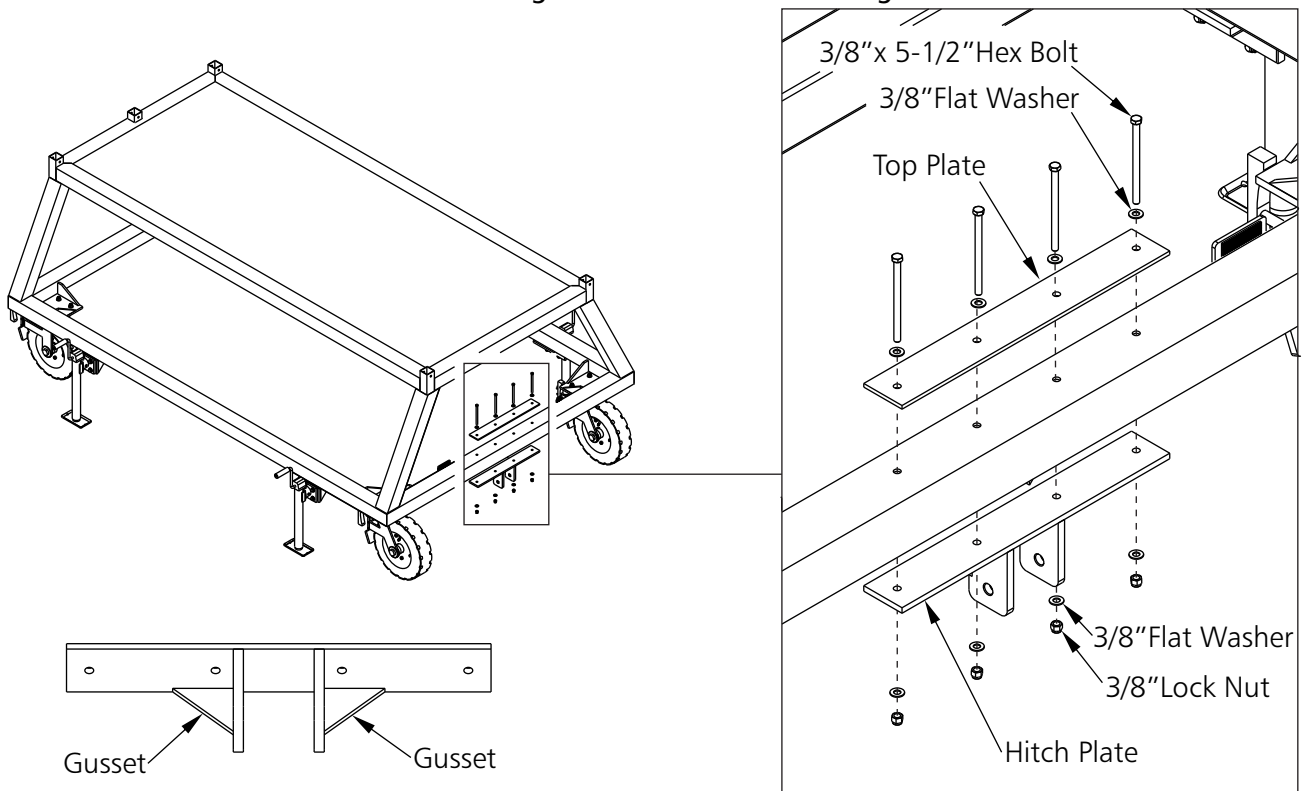

⚠ WARNING

THIS EQUIPMENT MUST BE STORED IN A SECURED, SHELTERED AREA WHEN NOT IN USE OR IN THE THREAT OF HIGH WINDS. ANY WEATHER DAMAGE TO THIS EQUIPMENT WILL NOT BE COVERED UNDER KWIK GOAL'S PRODUCT GUARANTEE. DO NOT LEAVE THIS EQUIPMENT UNATTENDED.

11. Attach the hitch coupler to the tow bar as shown.

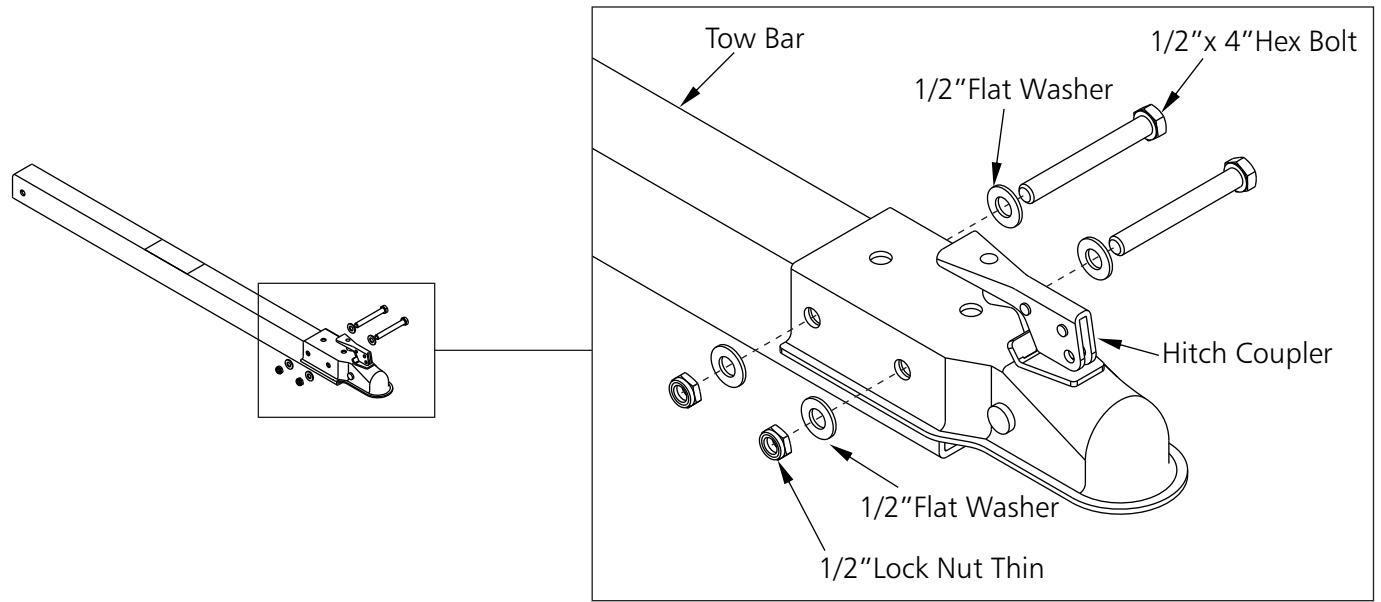

12. Store assembled tow hitch on hitch holders and secure it in place with the hitch pin.

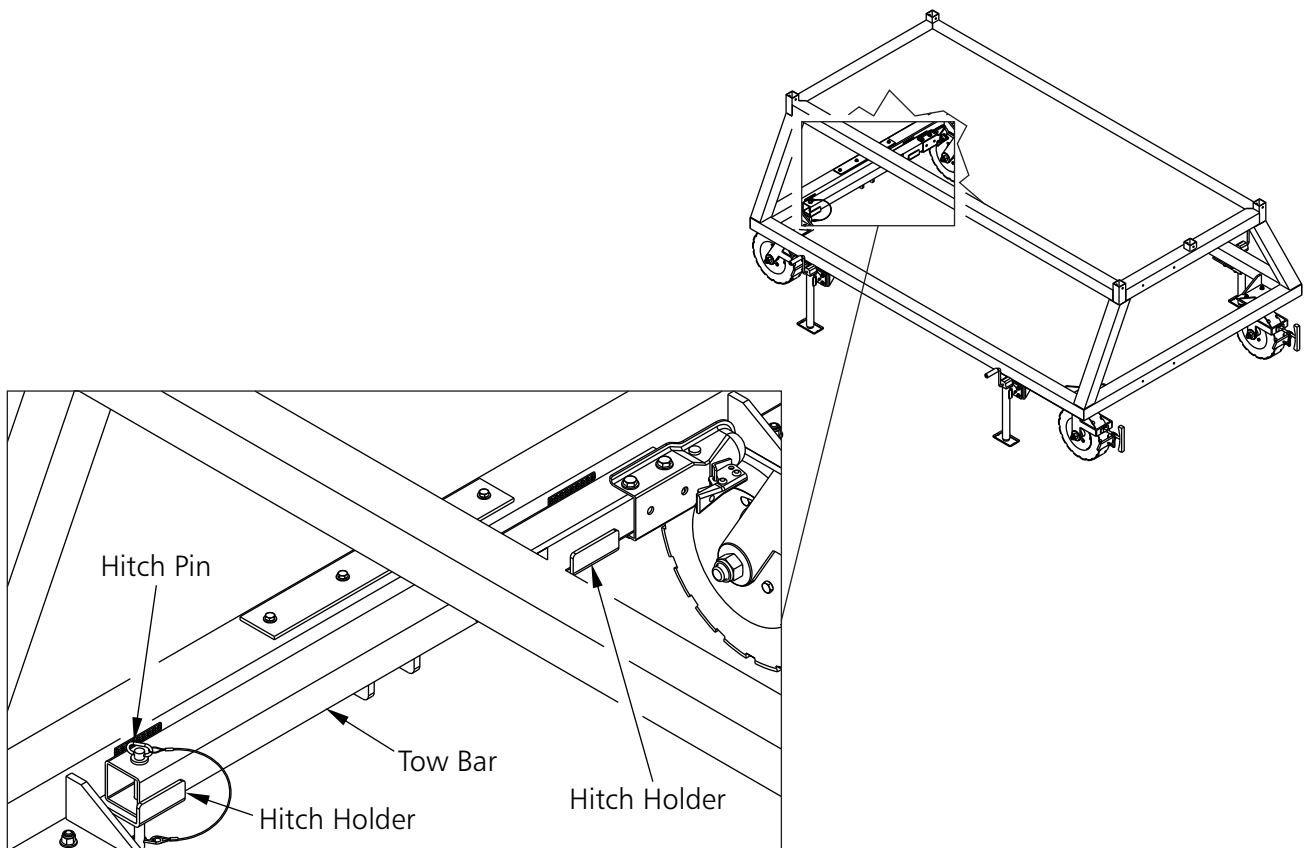

⚠ WARNING

THIS EQUIPMENT MUST BE STORED IN A SECURED, SHELTERED AREA WHEN NOT IN USE OR IN THE THREAT OF HIGH WINDS. ANY WEATHER DAMAGE TO THIS EQUIPMENT WILL NOT BE COVERED UNDER KWIK GOAL'S PRODUCT GUARANTEE. DO NOT LEAVE THIS EQUIPMENT UNATTENDED.

13. Hardware for this step is in the Ladder Hdw pack.
Attach the ladder assembly as shown.
Use caution not to overtighten bolts. Be sure inside of chassis tube does not distort.

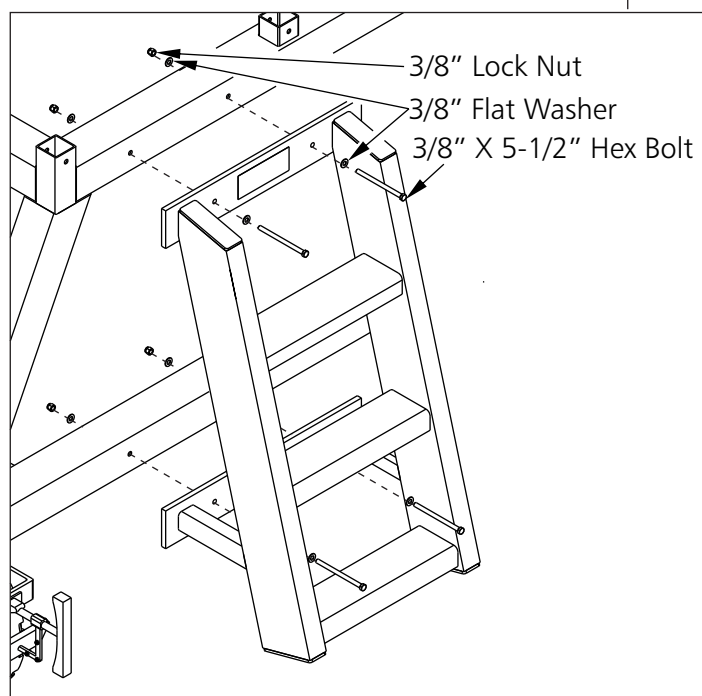
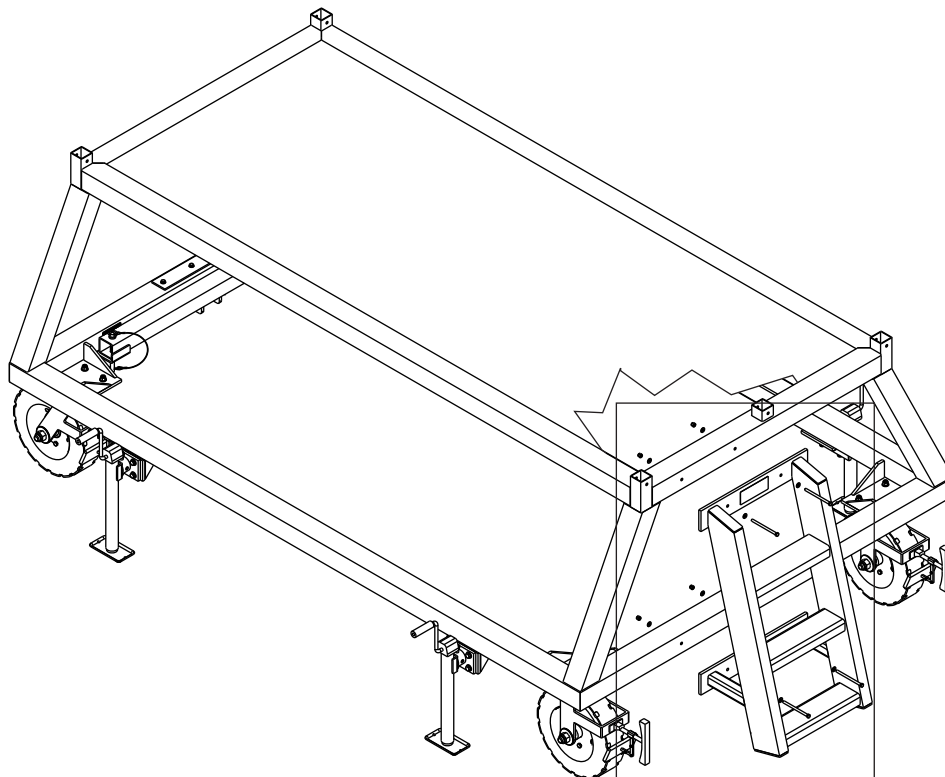

⚠ WARNING

THIS EQUIPMENT MUST BE STORED IN A SECURED, SHELTERED AREA WHEN NOT IN USE OR IN THE THREAT OF HIGH WINDS. ANY WEATHER DAMAGE TO THIS EQUIPMENT WILL NOT BE COVERED UNDER KWIK GOAL'S PRODUCT GUARANTEE. DO NOT LEAVE THIS EQUIPMENT UNATTENDED.

Parts for Cab Assembly

Front Railing (1)
(Part# UZ1632)

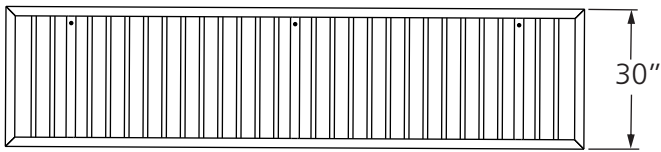

Entrance Railing (1)
(Part# UZ1629)

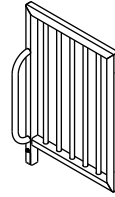

Rear Railing (1)
(Part# UZ1630)

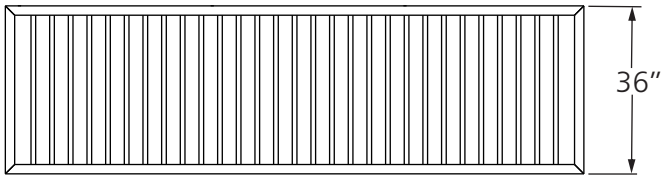

Left Side Railing (1)
(Part# UZ1631)

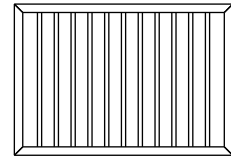

Panel (3)
(Part# UZ1633)

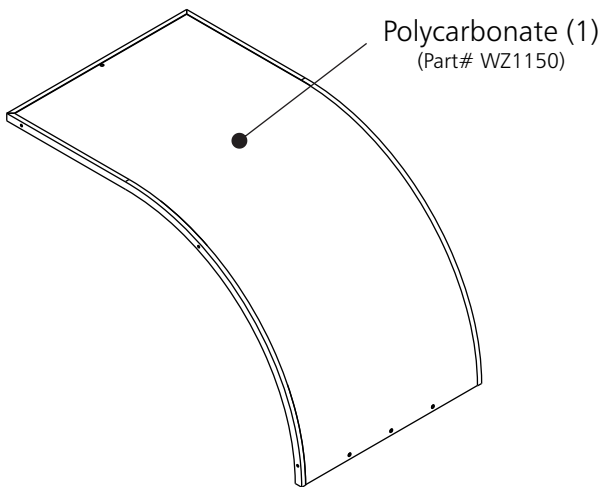

Left Post (1)
(Part# UZ1634)

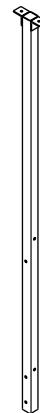

Right Post (1)
(Part# UZ1643)



Cab Bow (2)
(Part# UZ1636)

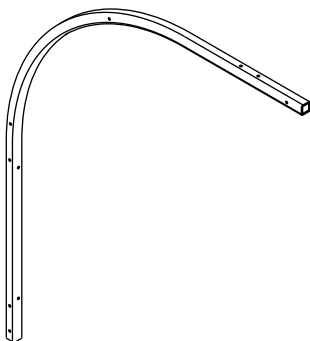

Plank (3)
(Part# UZ1115)

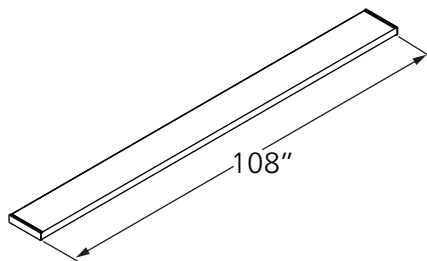

Plank Bracket (3)
(Part# UZ1644)

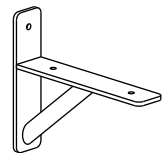

⚠ WARNING

THIS EQUIPMENT MUST BE STORED IN A SECURED, SHELTERED AREA WHEN NOT IN USE OR IN THE THREAT OF HIGH WINDS. ANY WEATHER DAMAGE TO THIS EQUIPMENT WILL NOT BE COVERED UNDER KWIK GOAL'S PRODUCT GUARANTEE. DO NOT LEAVE THIS EQUIPMENT UNATTENDED.

Note: Hardware is packed separately in one or more boxes. Open all boxes and layout all sealed hardware packs before beginning assembly.

Railing Hdw (Part#JZ241)

3/8" Flat Washer (Part# TZ189)	(10)
3/8" Lock Nut (Part# TZ197)	(5)
3/8" X 3-1/4" Hex Bolt (Part# TZ406)	(5)
5/16" Lock Nut Thin (Part# TZ321)	(18)
5/16" X 2-3/4" Hex Bolt (Part# TZ338)	(4)
5/16" X 4-1/2" Hex Bolt (Part# TZ377)	(14)
5/16" Flat Washer (Part# TZ4)	(36)

Panel Hdw (Part#JZ242)

5/16" Lock Nut Thin (Part# TZ321)	(12)
5/16" Flat Washer (Part# TZ4)	(27)
5/16" Lock Washer (Part#TZ174)	(3)
5/16" X 4" Hex Bolt (Part# TZ116)	(6)
5/16" X 3-3/4" Hex Bolt (Part# TZ264)	(6)
5/16" X 1-1/4" Hex Bolt (Part# TZ311)	(3)

Shelf Hdw (Part#JZ252)

5/16" Lock Washer (Part#TZ174)	(3)
5/16" Flat Washer (Part# TZ4)	(9)
5/16" X 1" Hex Bolt (Part# TZ330)	(3)
5/16" X 1-1/4" Carriage Bolt (Part# TZ350)	(6)
5/16" Lock Nut (Part#TZ5)	(6)
Bench Hold Down (Part#UZ475)	(6)

Bench Hdw (Part#JZ261)

5/16" x 3" Carriage Bolt (Part# TZ172)	(12)
5/16" x 2-3/4" Carriage Bolt (Part# TZ191)	(3)
5/16" Lock Nut (Part# TZ5)	(15)
5/16" Flat Washer (Part# TZ4)	(15)
Bench Hold Down (Part#UZ475)	(12)
Rubber Pads (Part#VZ654)	(6)

Bench Hold Down (See Above)
(Part# UZ475)

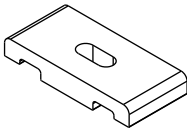

Bench Frame (3)
(Part# UZ469)

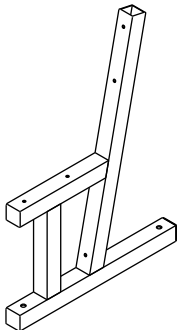

Frame Support (1)
(Part# UZ1661)

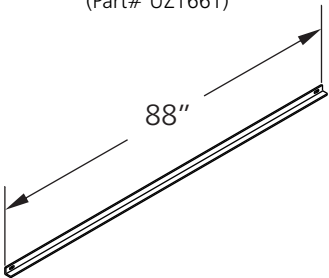

▲WARNING

THIS EQUIPMENT MUST BE STORED IN A SECURED, SHELTERED AREA WHEN NOT IN USE OR IN THE THREAT OF HIGH WINDS. ANY WEATHER DAMAGE TO THIS EQUIPMENT WILL NOT BE COVERED UNDER KWIK GOAL'S PRODUCT GUARANTEE. DO NOT LEAVE THIS EQUIPMENT UNATTENDED.

14. Hardware for steps 14 through 19 are in the Railing Hdw pack.
Attach the right post and cab bow as shown below.
Do Not tighten bolts at this time.

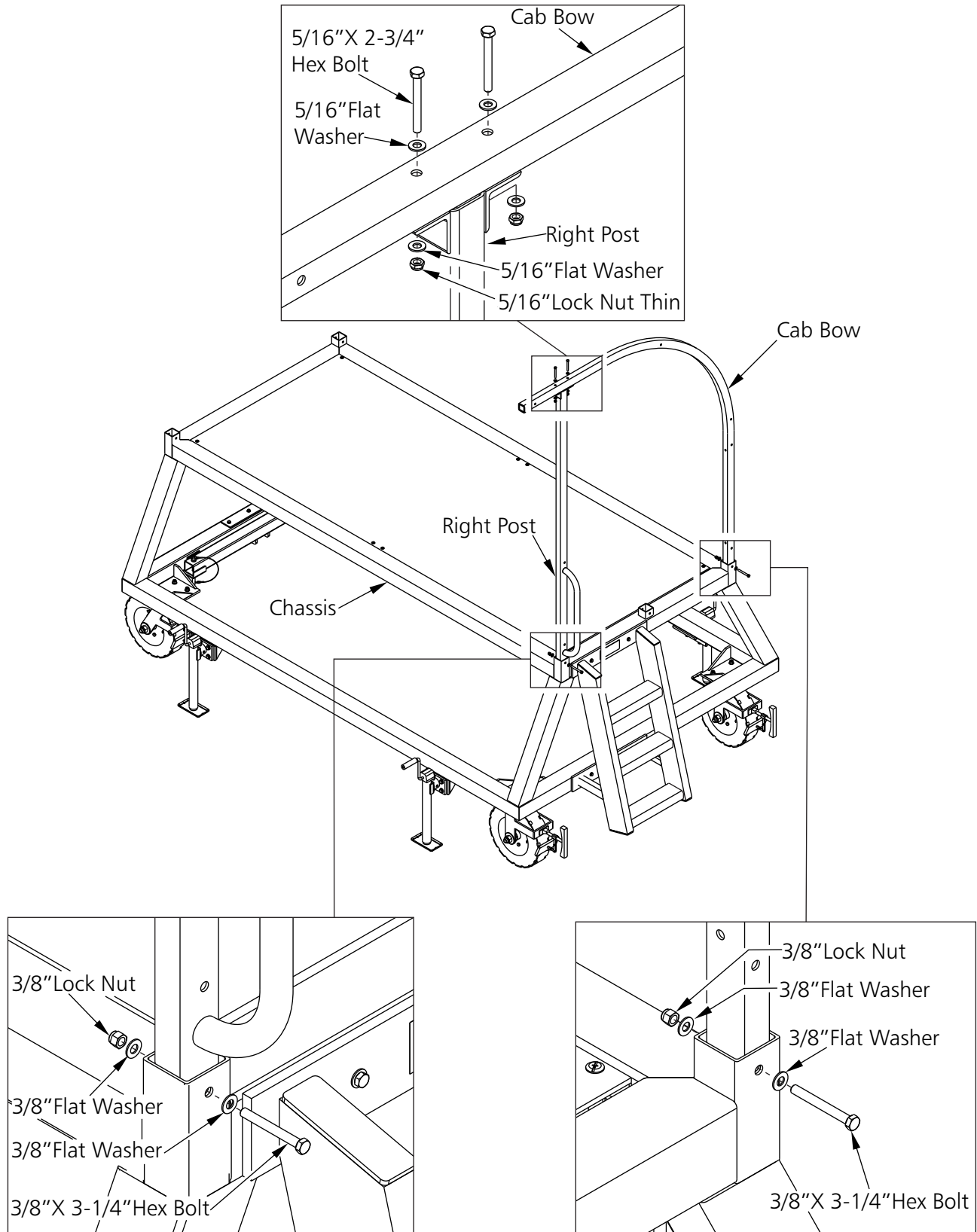

▲WARNING

THIS EQUIPMENT MUST BE STORED IN A SECURED, SHELTERED AREA WHEN NOT IN USE OR IN THE THREAT OF HIGH WINDS. ANY WEATHER DAMAGE TO THIS EQUIPMENT WILL NOT BE COVERED UNDER KWIK GOAL'S PRODUCT GUARANTEE. DO NOT LEAVE THIS EQUIPMENT UNATTENDED.

15. Attach the entrance railing to the chassis and cab bow as shown.
Do Not tighten bolts at this time.

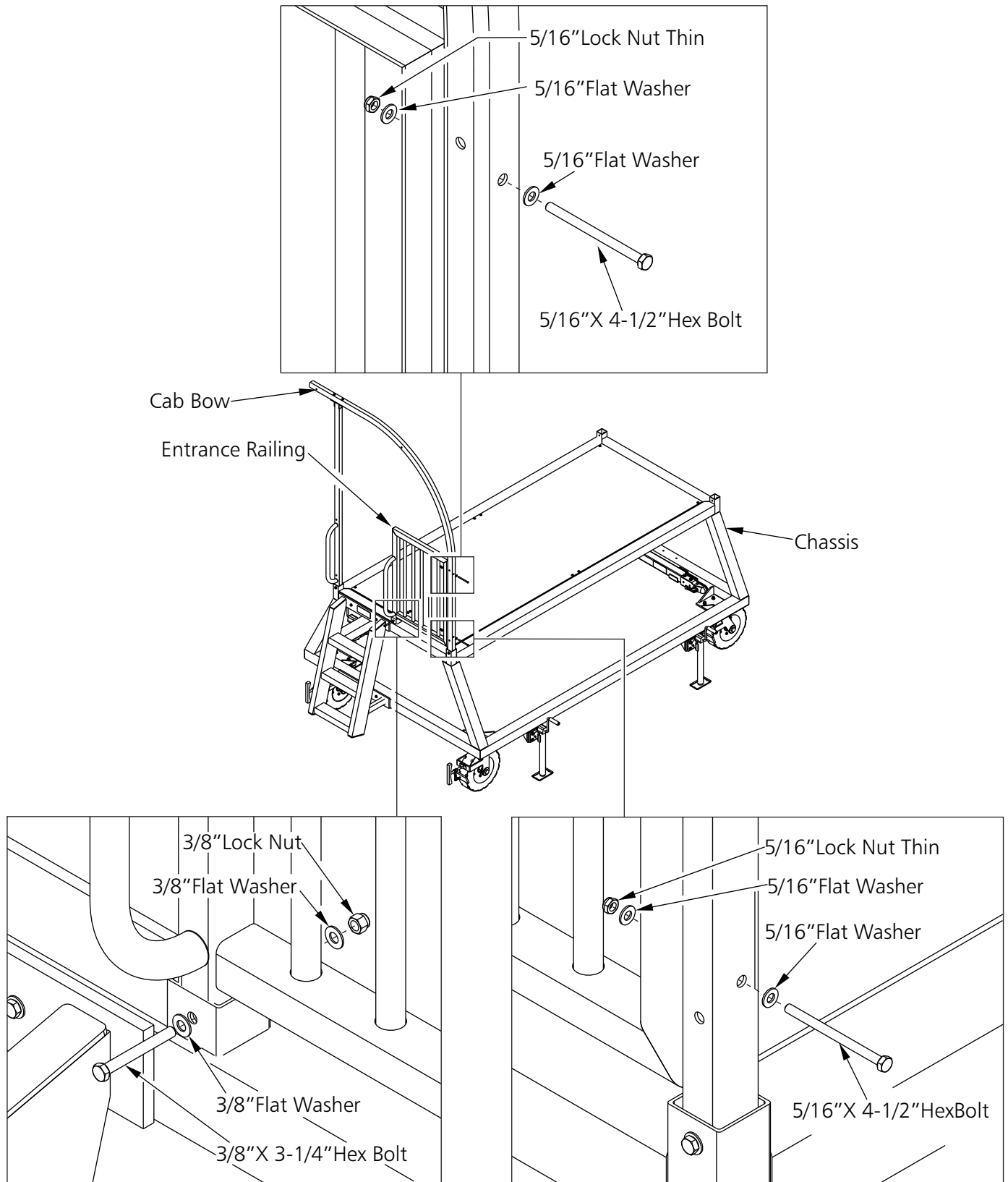

▲WARNING

THIS EQUIPMENT MUST BE STORED IN A SECURED, SHELTERED AREA WHEN NOT IN USE OR IN THE THREAT OF HIGH WINDS. ANY WEATHER DAMAGE TO THIS EQUIPMENT WILL NOT BE COVERED UNDER KWIK GOAL'S PRODUCT GUARANTEE. DO NOT LEAVE THIS EQUIPMENT UNATTENDED.

16. Attach the second cab bow to the left post and the chassis as shown below.
Do Not tighten bolts at this time.

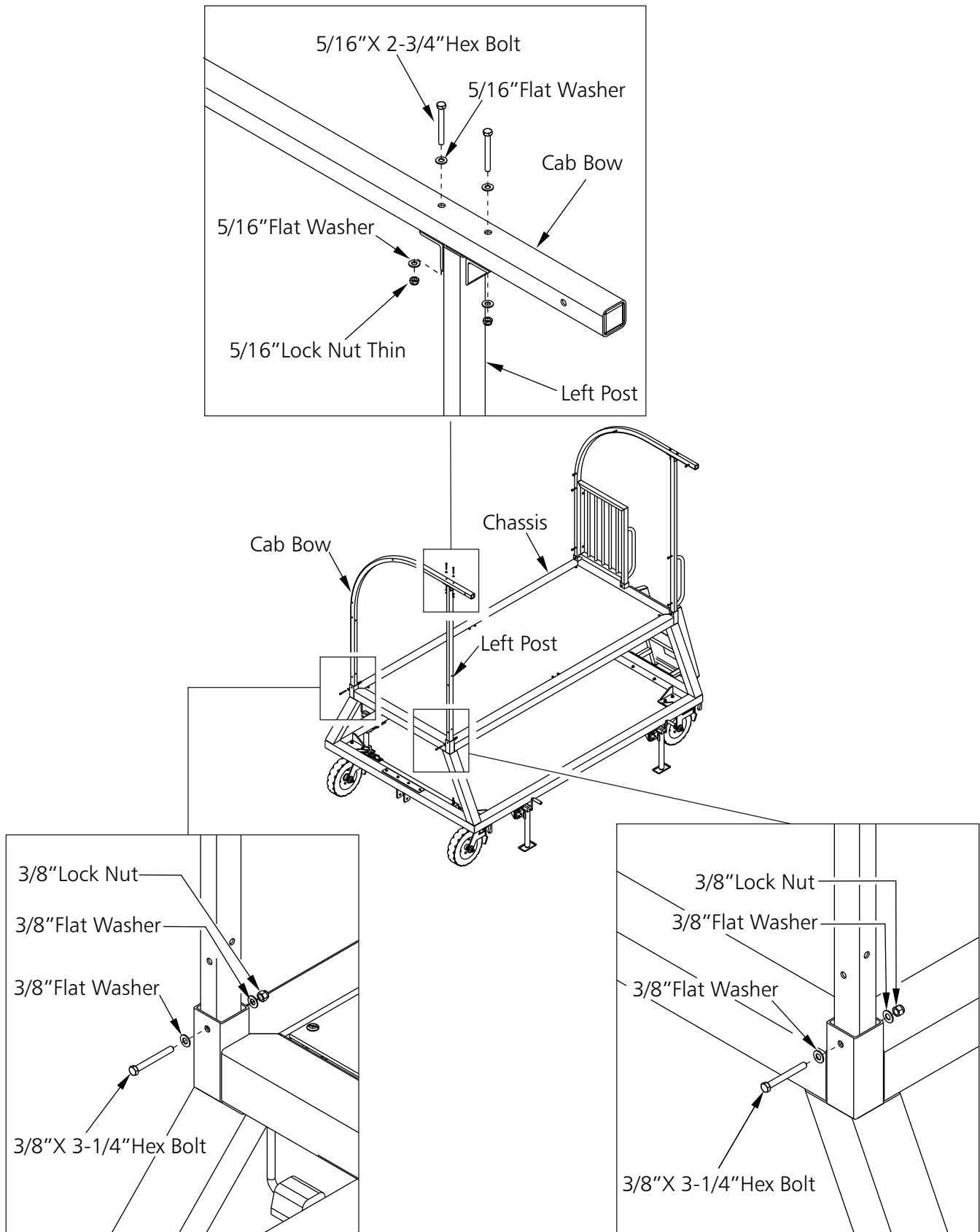

⚠ WARNING

THIS EQUIPMENT MUST BE STORED IN A SECURED, SHELTERED AREA WHEN NOT IN USE OR IN THE THREAT OF HIGH WINDS. ANY WEATHER DAMAGE TO THIS EQUIPMENT WILL NOT BE COVERED UNDER KWIK GOAL'S PRODUCT GUARANTEE. DO NOT LEAVE THIS EQUIPMENT UNATTENDED.

17. Attach the left side railing to the bow and post as shown.
Do Not tighten bolts at this time.

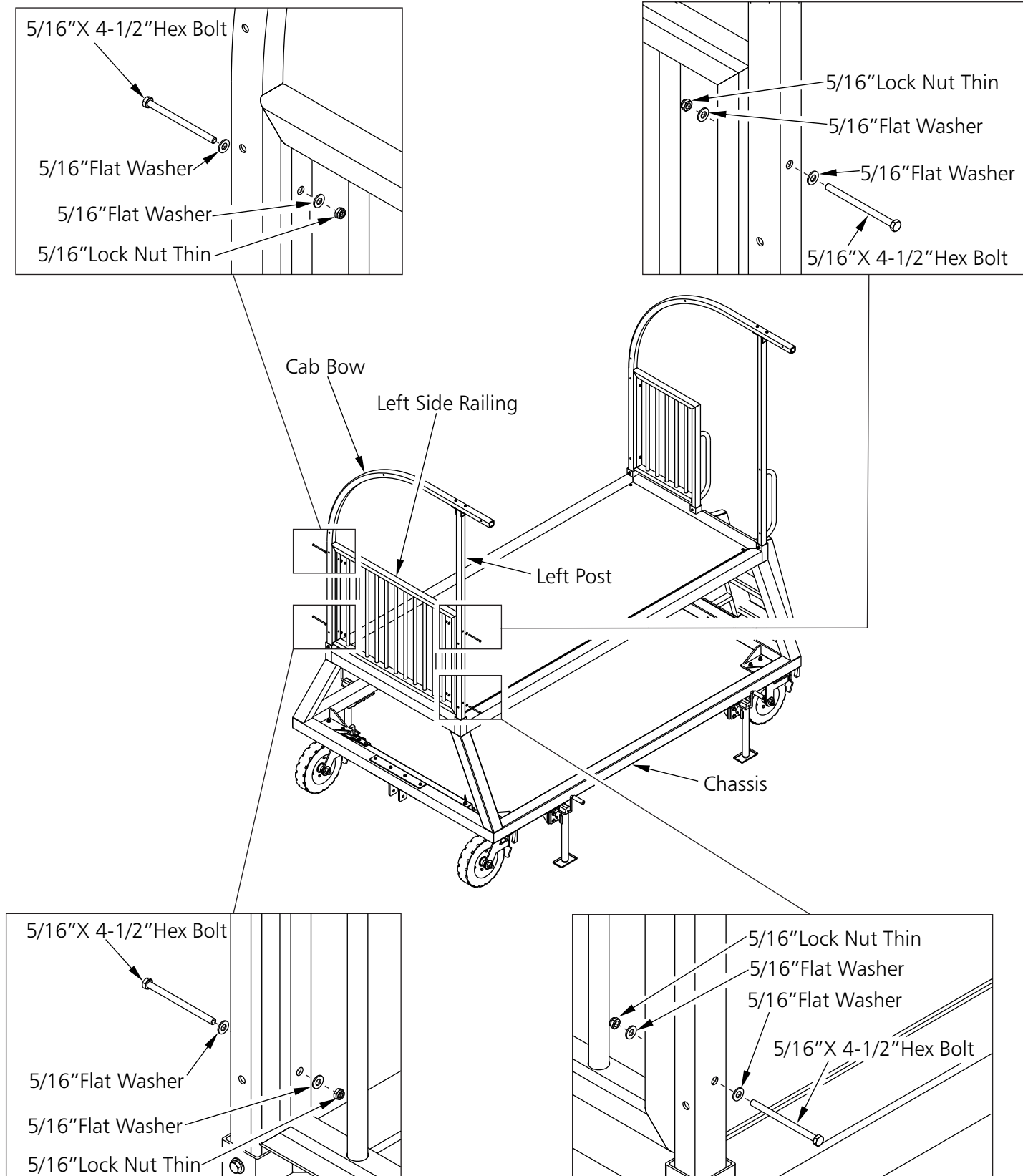

⚠ WARNING

THIS EQUIPMENT MUST BE STORED IN A SECURED, SHELTERED AREA WHEN NOT IN USE OR IN THE THREAT OF HIGH WINDS. ANY WEATHER DAMAGE TO THIS EQUIPMENT WILL NOT BE COVERED UNDER KWIK GOAL'S PRODUCT GUARANTEE. DO NOT LEAVE THIS EQUIPMENT UNATTENDED.

18. Attach the rear railing to cab bows as shown below. Make sure the riv-nut inserts on the top rail of the assembly are toward the left side railing.

Do Not tighten bolts at this time.

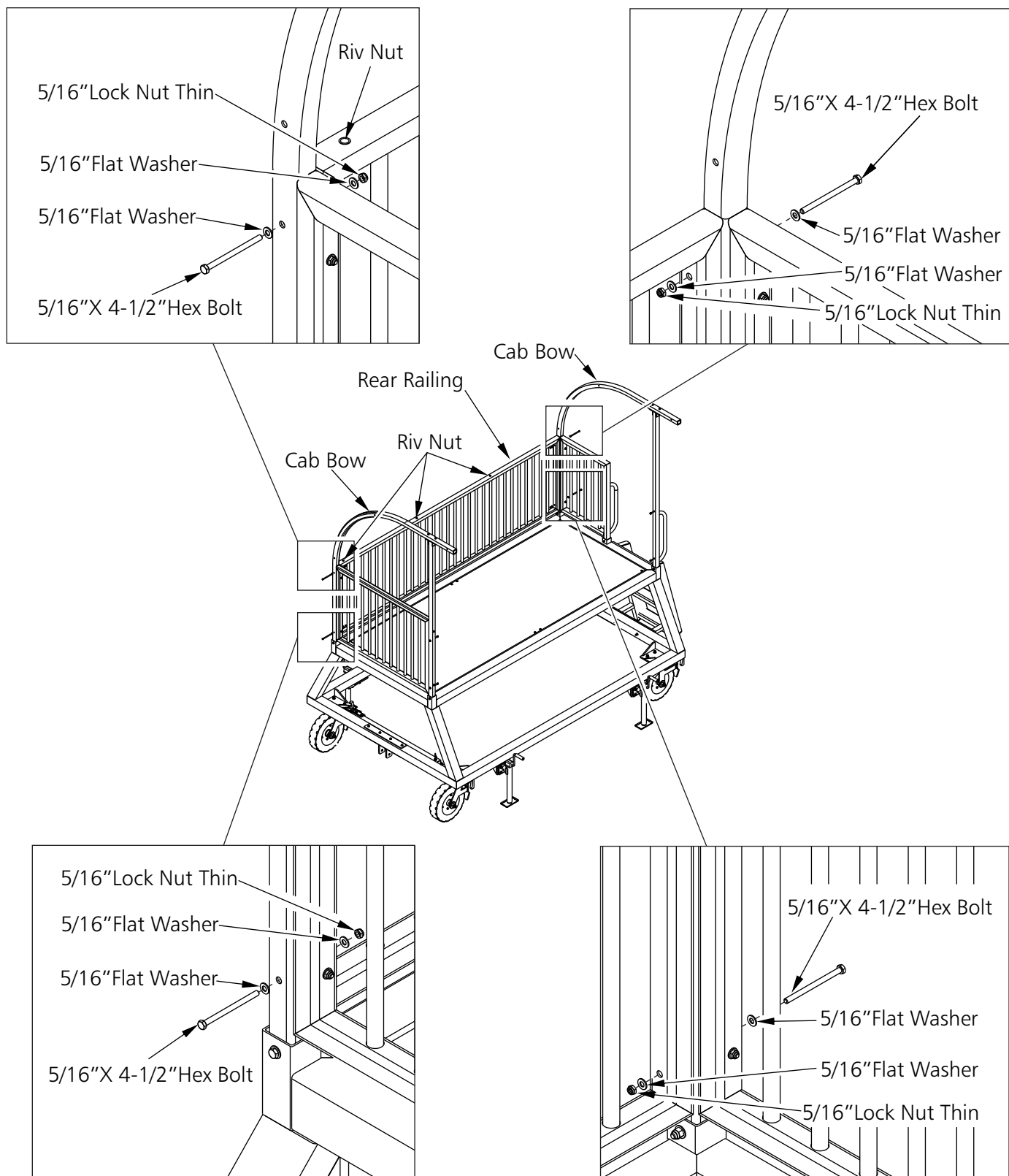

⚠ WARNING

THIS EQUIPMENT MUST BE STORED IN A SECURED, SHELTERED AREA WHEN NOT IN USE OR IN THE THREAT OF HIGH WINDS. ANY WEATHER DAMAGE TO THIS EQUIPMENT WILL NOT BE COVERED UNDER KWIK GOAL'S PRODUCT GUARANTEE. DO NOT LEAVE THIS EQUIPMENT UNATTENDED.

19. Attach front railing to right and left posts as shown. Make sure riv-nuts are facing inside cab.
Do Not tighten bolts at this time.

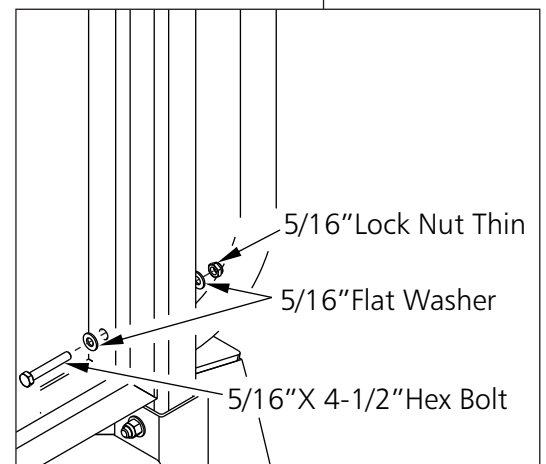
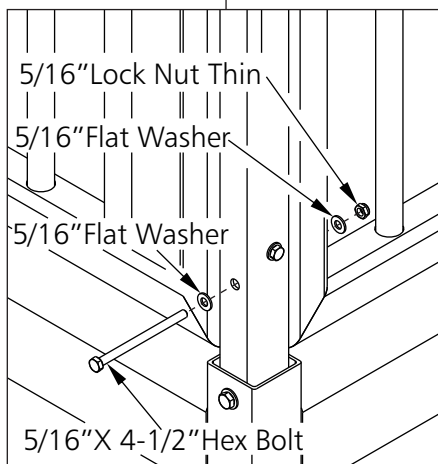
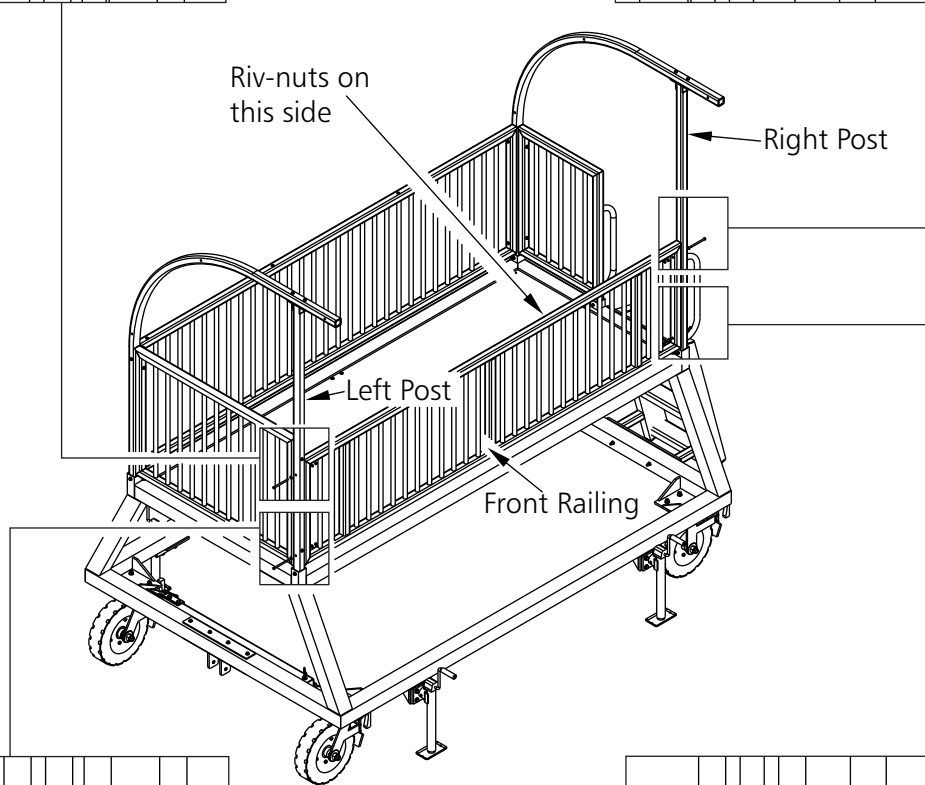
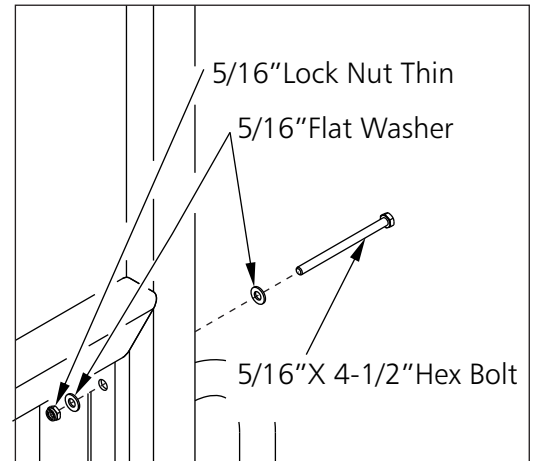
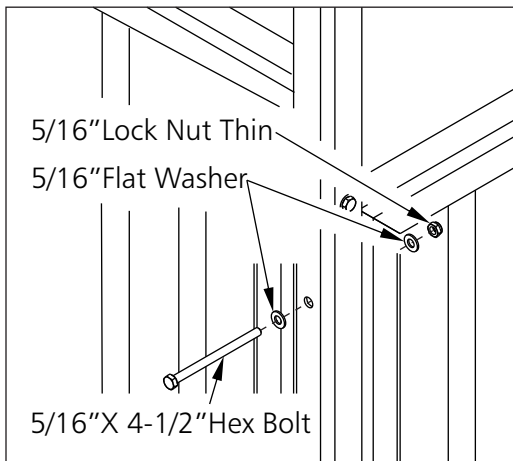

⚠ WARNING

THIS EQUIPMENT MUST BE STORED IN A SECURED, SHELTERED AREA WHEN NOT IN USE OR IN THE THREAT OF HIGH WINDS. ANY WEATHER DAMAGE TO THIS EQUIPMENT WILL NOT BE COVERED UNDER KWIK GOAL'S PRODUCT GUARANTEE. DO NOT LEAVE THIS EQUIPMENT UNATTENDED.

20. Hardware for steps 20 and 21 are in the **Panel Hdw** pack.
Attach one panel to each of the cab bows and rear railing as shown.
Do Not tighten bolts at this time.

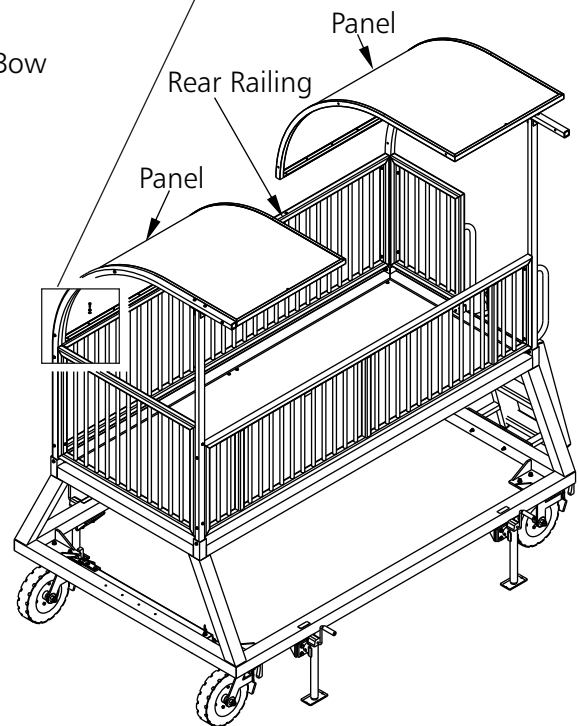
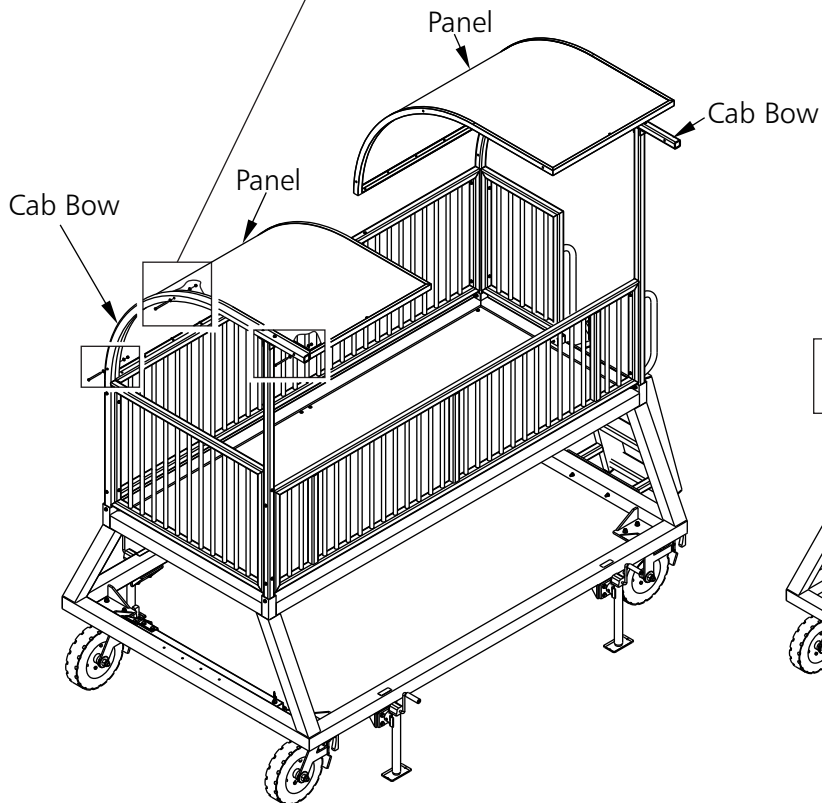
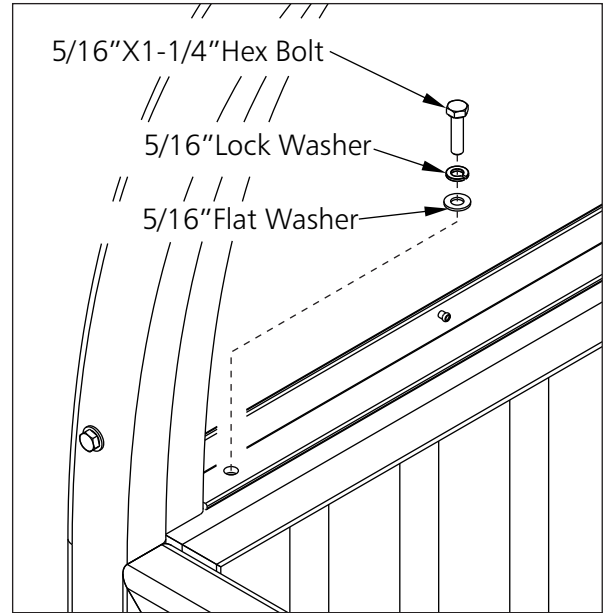
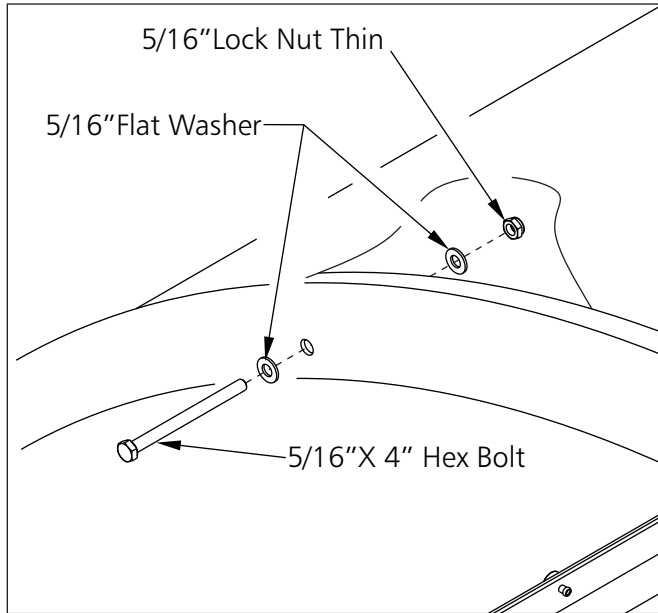

⚠ WARNING

THIS EQUIPMENT MUST BE STORED IN A SECURED, SHELTERED AREA WHEN NOT IN USE OR IN THE THREAT OF HIGH WINDS. ANY WEATHER DAMAGE TO THIS EQUIPMENT WILL NOT BE COVERED UNDER KWIK GOAL'S PRODUCT GUARANTEE. DO NOT LEAVE THIS EQUIPMENT UNATTENDED.

21. Attach remaining center panel and tighten all bolts on posts, bows, panels, and railings.
Do Not overtighten bolts.

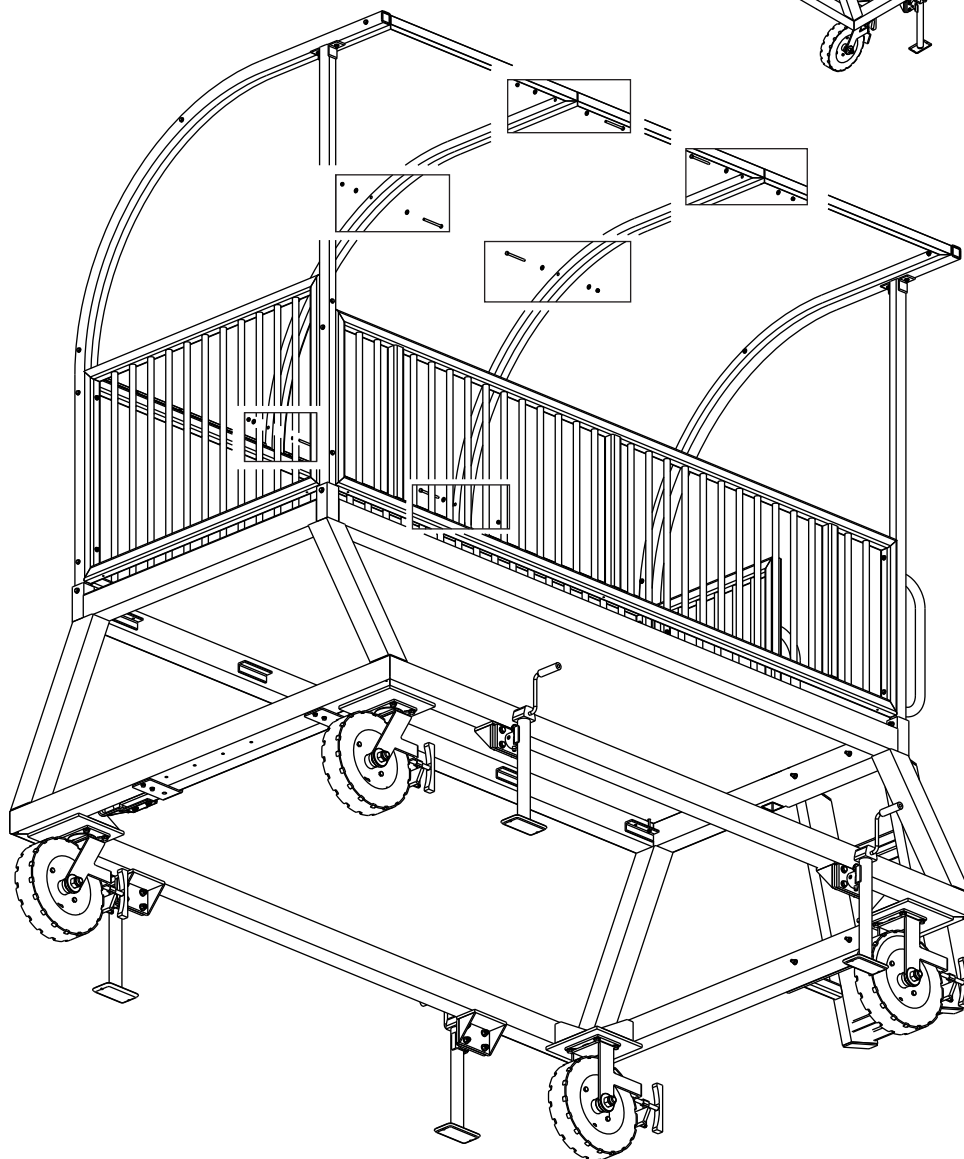
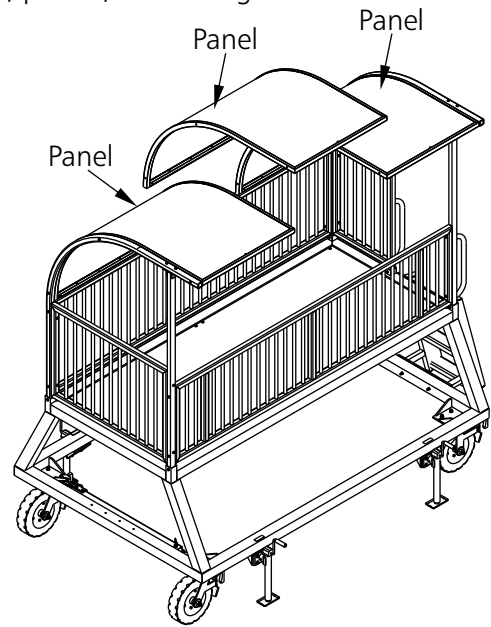
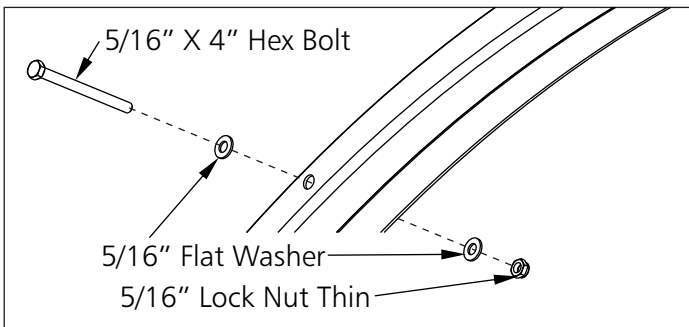

⚠ WARNING

THIS EQUIPMENT MUST BE STORED IN A SECURED, SHELTERED AREA WHEN NOT IN USE OR IN THE THREAT OF HIGH WINDS. ANY WEATHER DAMAGE TO THIS EQUIPMENT WILL NOT BE COVERED UNDER KWIK GOAL'S PRODUCT GUARANTEE. DO NOT LEAVE THIS EQUIPMENT UNATTENDED.

22. Hardware for steps 22 and 23 are in the **Shelf Hdw** pack.
Attach plank brackets to front railing at locations shown.

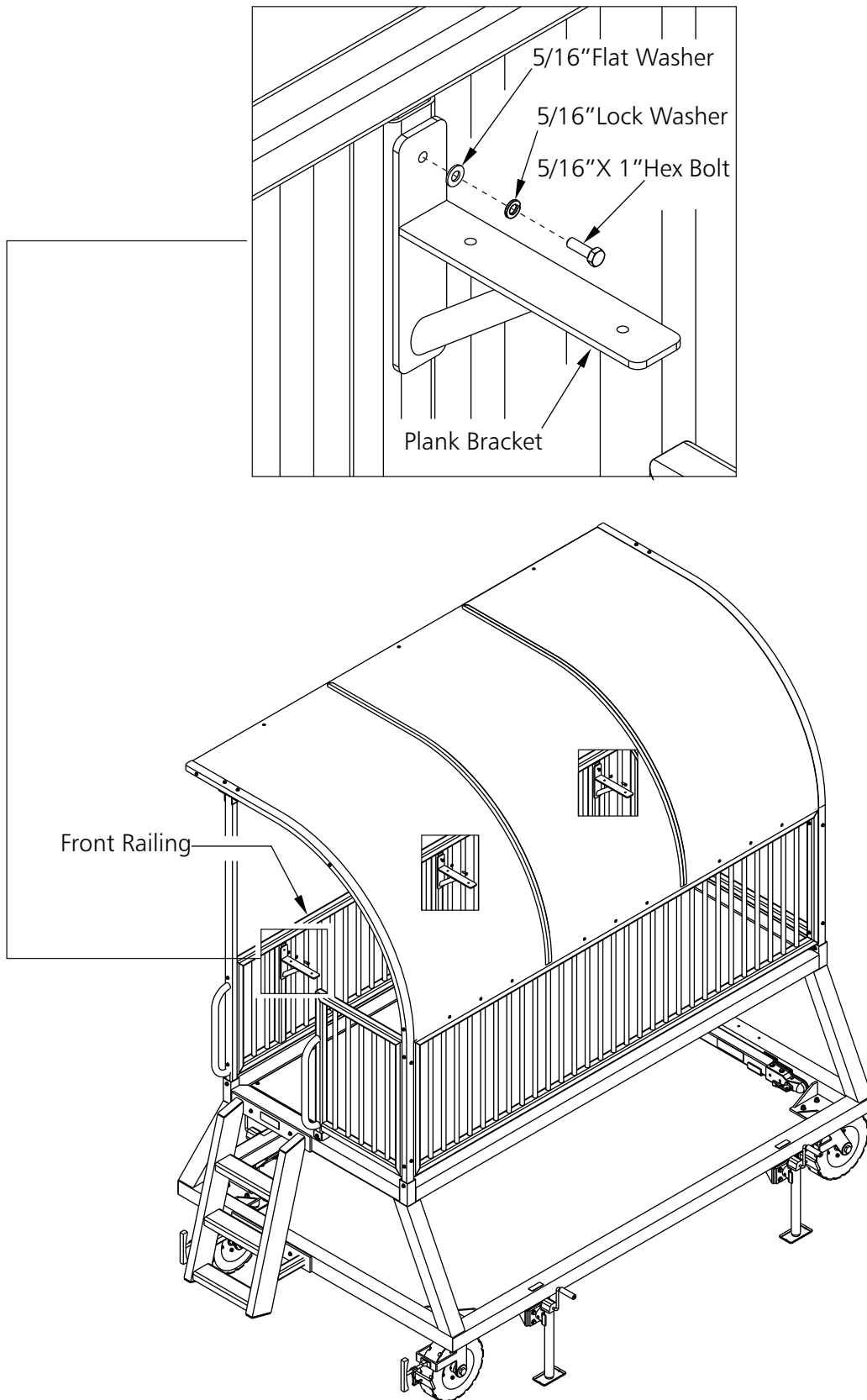

▲WARNING

THIS EQUIPMENT MUST BE STORED IN A SECURED, SHELTERED AREA WHEN NOT IN USE OR IN THE THREAT OF HIGH WINDS. ANY WEATHER DAMAGE TO THIS EQUIPMENT WILL NOT BE COVERED UNDER KWIK GOAL'S PRODUCT GUARANTEE. DO NOT LEAVE THIS EQUIPMENT UNATTENDED.

23. To attach plank to plank brackets align bench hold down parallel with slot in plank, insert, and turn ninety degrees (quarter turn).

Note: Center plank on plank brackets before tightening bolts.

Do not overtighten bolts

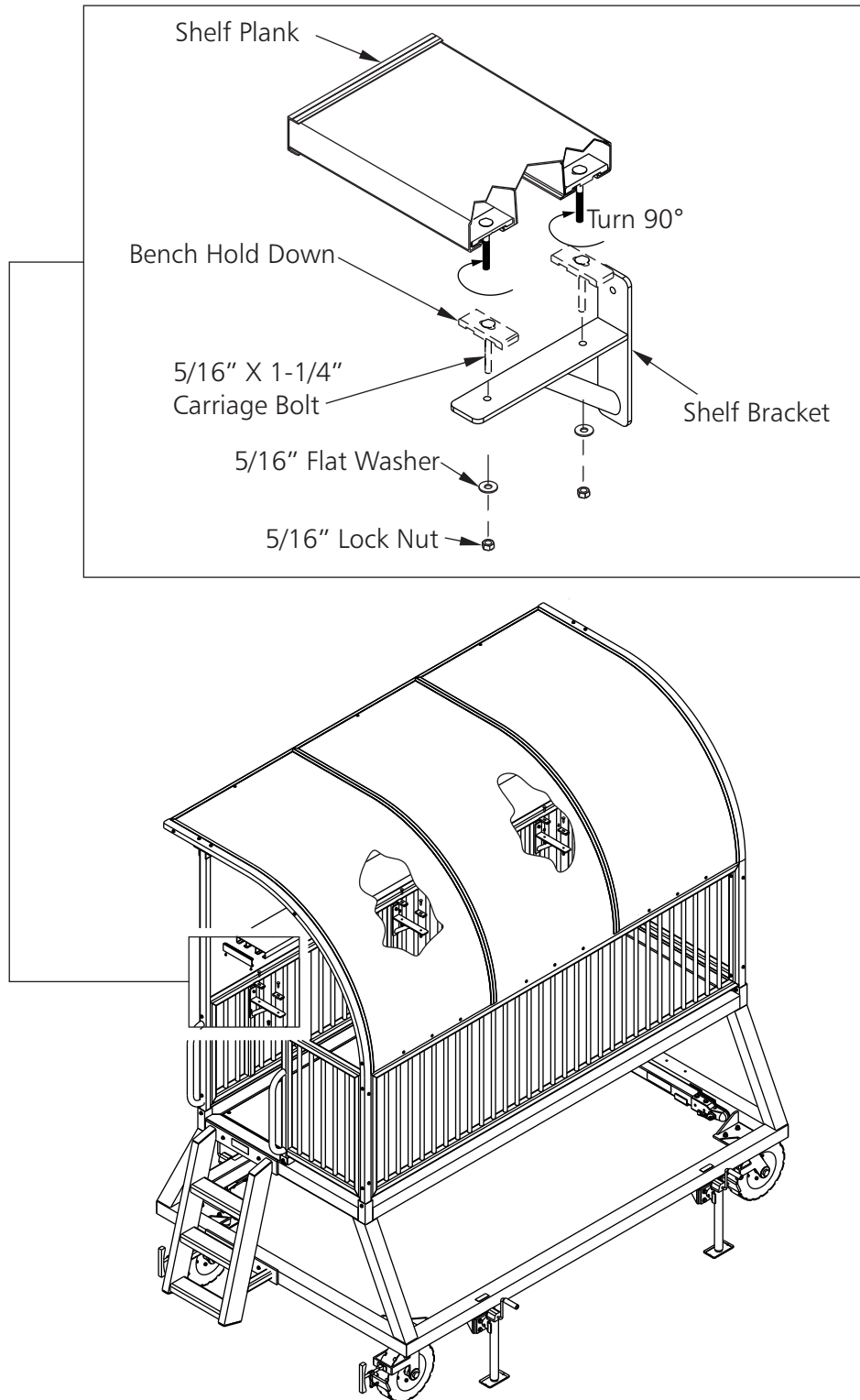

▲WARNING

THIS EQUIPMENT MUST BE STORED IN A SECURED, SHELTERED AREA WHEN NOT IN USE OR IN THE THREAT OF HIGH WINDS. ANY WEATHER DAMAGE TO THIS EQUIPMENT WILL NOT BE COVERED UNDER KWIK GOAL'S PRODUCT GUARANTEE. DO NOT LEAVE THIS EQUIPMENT UNATTENDED.

24. Hardware for steps 24 and 25 are in the **Bench Hdw** pack.

Attach rubber pads to bottom of bench frames.

Center the first bench plank at location shown. Attach bench plank to each bench frame. Align bench hold down parallel with slot in bench plank, insert, and turn ninety degrees (quarter turn) to attach bench plank to bench frame.

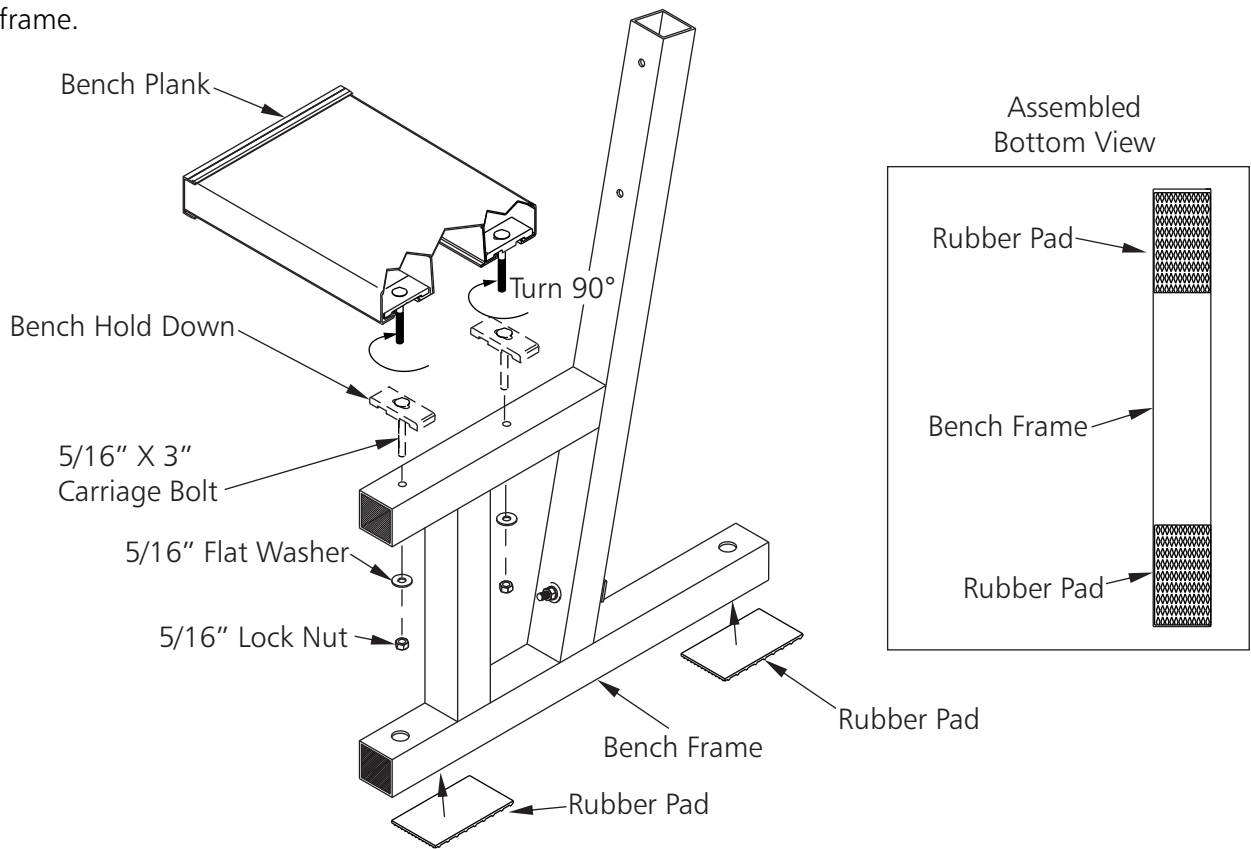

25. Center and attach second bench plank to bench frames, also attach frame support to bench frames. Tighten all plank and support bolts.

Do not overtighten bolts.

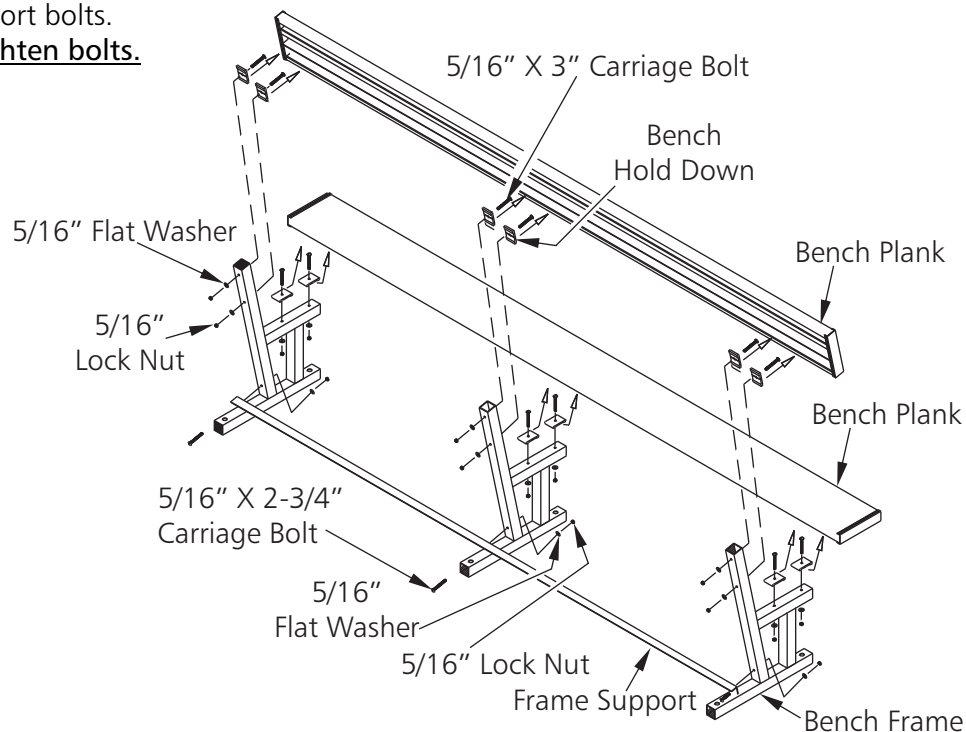

⚠ WARNING

THIS EQUIPMENT MUST BE STORED IN A SECURED, SHELTERED AREA WHEN NOT IN USE OR IN THE THREAT OF HIGH WINDS. ANY WEATHER DAMAGE TO THIS EQUIPMENT WILL NOT BE COVERED UNDER KWIK GOAL'S PRODUCT GUARANTEE. DO NOT LEAVE THIS EQUIPMENT UNATTENDED.

26. Review all safety instructions and warnings prior to moving tower.

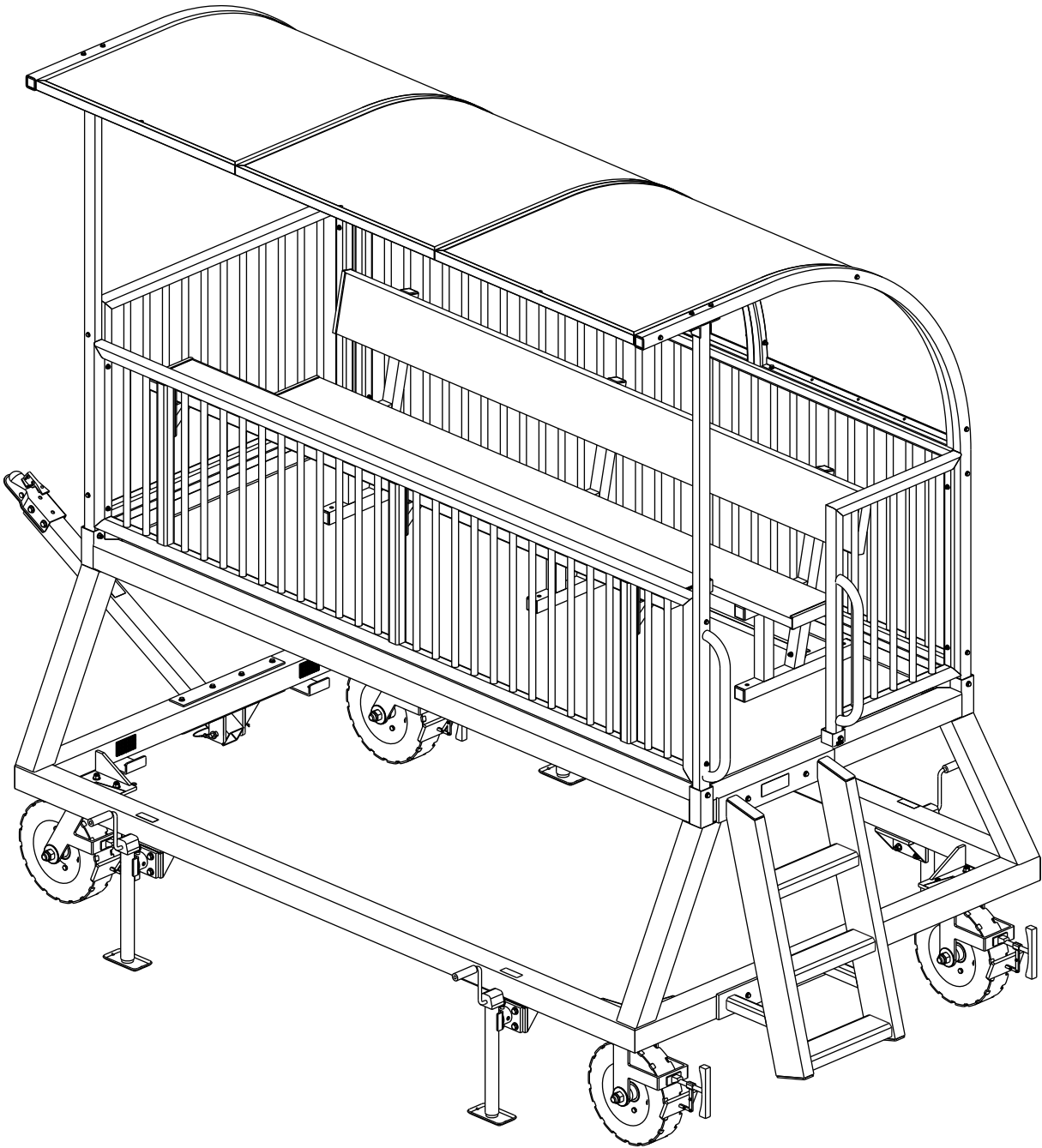

Go to kwikgoal.com for additional product information.

⚠ WARNING

THIS EQUIPMENT MUST BE STORED IN A SECURED, SHELTERED AREA WHEN NOT IN USE OR IN THE THREAT OF HIGH WINDS. ANY WEATHER DAMAGE TO THIS EQUIPMENT WILL NOT BE COVERED UNDER KWIK GOAL'S PRODUCT GUARANTEE. DO NOT LEAVE THIS EQUIPMENT UNATTENDED.